



LIN Mounted Light Kit Installation (Elevance Chairs Only) [002-1688-00]



Warning

Always disconnect power before removing covers.
Failure to do so may result in personal injury.

Attention!

Electrical installations must be completed
by a Licensed Electrician.

Components:

LIN Conn. Harness. 1
Strain Relief..... 1
Wall Cover..... 1

Special Tools:

none

Language of origin: English

Step 1: Access Power Supply.

- A) Disconnect power.
- B) Remove cover(s) as needed.

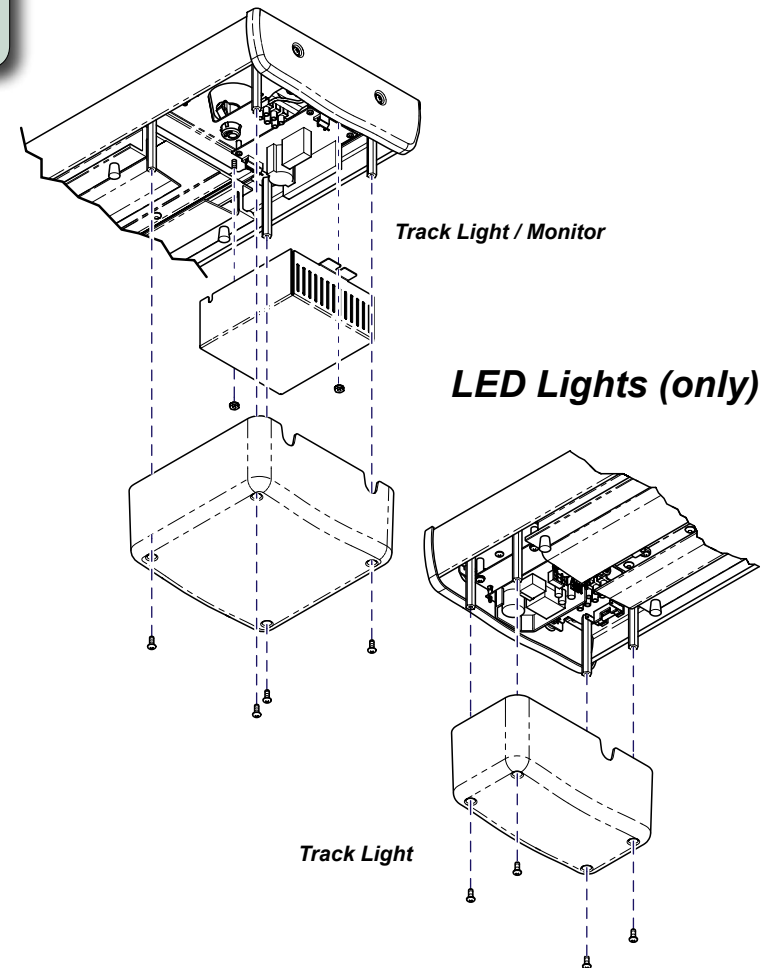
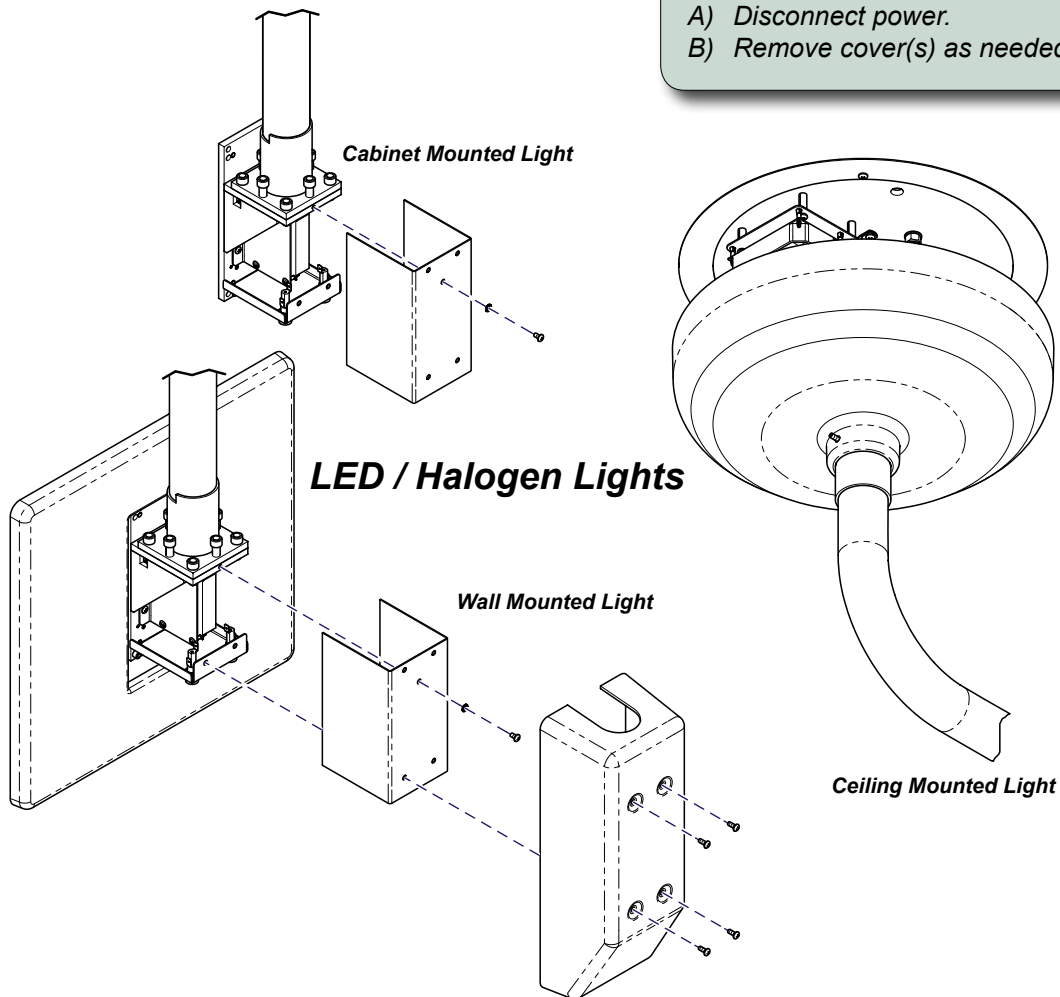

DA3991i

Track Mounted Light Disconnections

Step 2: Disconnect Power Cord.

- A) Loosen screws on terminal block.
- B) Remove power cord wires from terminal block.

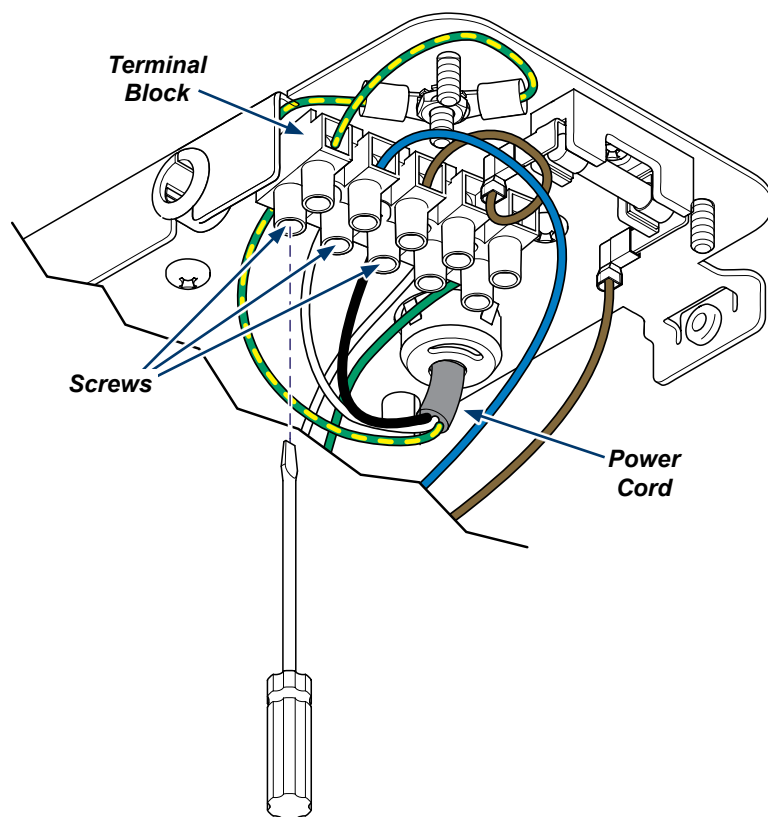

Step 3: Remove Power Cord.

- A) Remove strain relief from ceiling plate.
- B) Pull power cord wires thru ceiling plate.

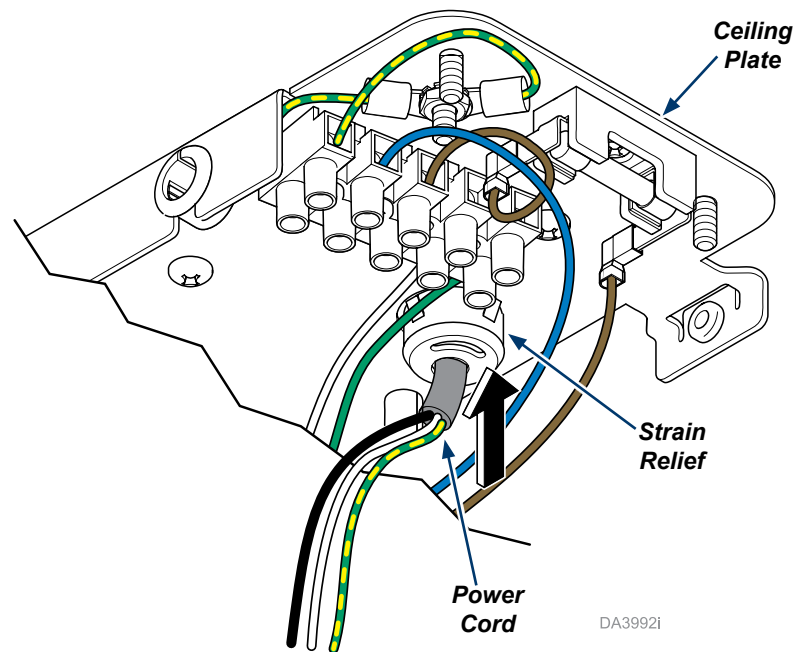

DA3992i

LIN Installation (Track Mounted Lights)

Step 3: LIN connection preparation.

- A) If necessary to run wiring use 30 foot cable provided.
- B) Cut off quick disconnects.
- C) Strip approximately 1/4 inch of insulation off both wires.

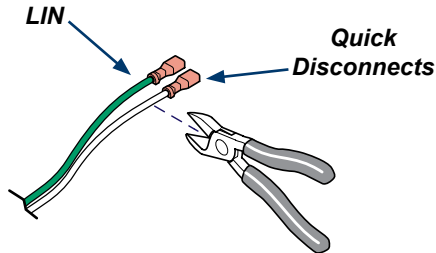

Step 4: Install Strain Relief.

- A) Feed LIN connector and power cord thru both new strain relief (provided) and ceiling plate.
- B) Install strain relief into ceiling plate.

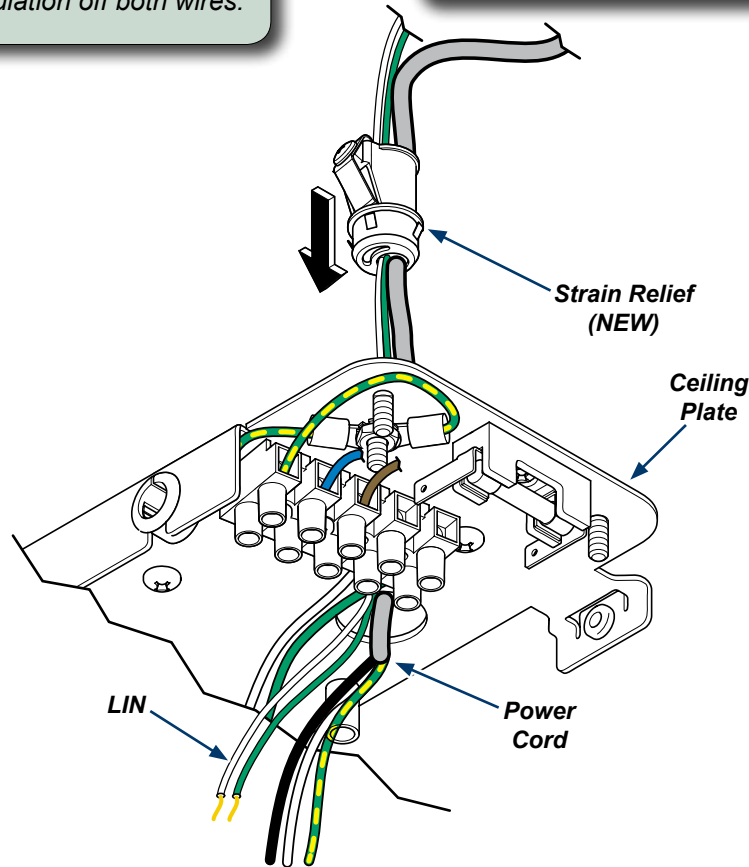

Step 5: Connect Wires.

- A) Insert power cord and LIN connector wires into terminal block as shown.
- B) Tighten terminal block screws.
- C) Route LIN wires to base of chair as required by facility.
- D) Go to Last Page in this instructions to see LIN connection to Elevance Chair.

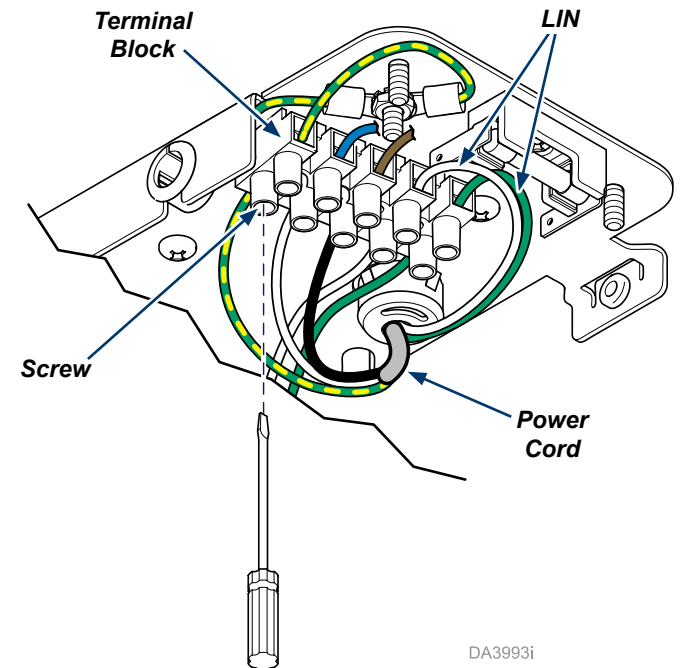

DA3993i

Ceiling Mounted Light Disconnections

Step 2: Disconnect Power Cord.

- A) Loosen screws on terminal block.
- B) Remove power cord wires from terminal block.
- C) Remove cable clamp from ceiling plate.

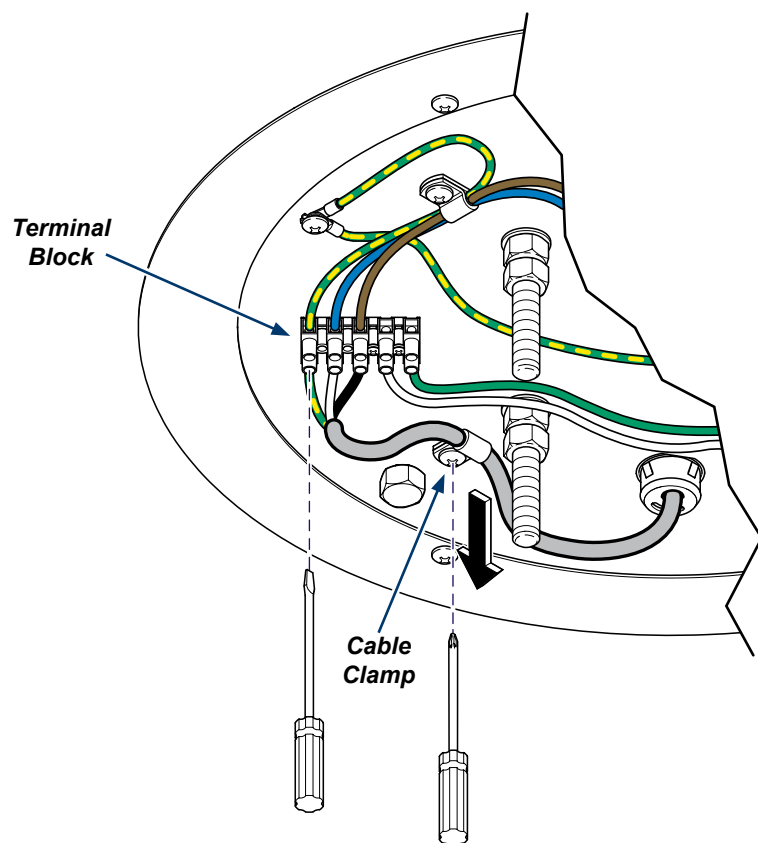

Step 3: Remove Power Cord.

- A) Remove strain relief from ceiling plate.
- B) Pull power cord wires thru ceiling plate.

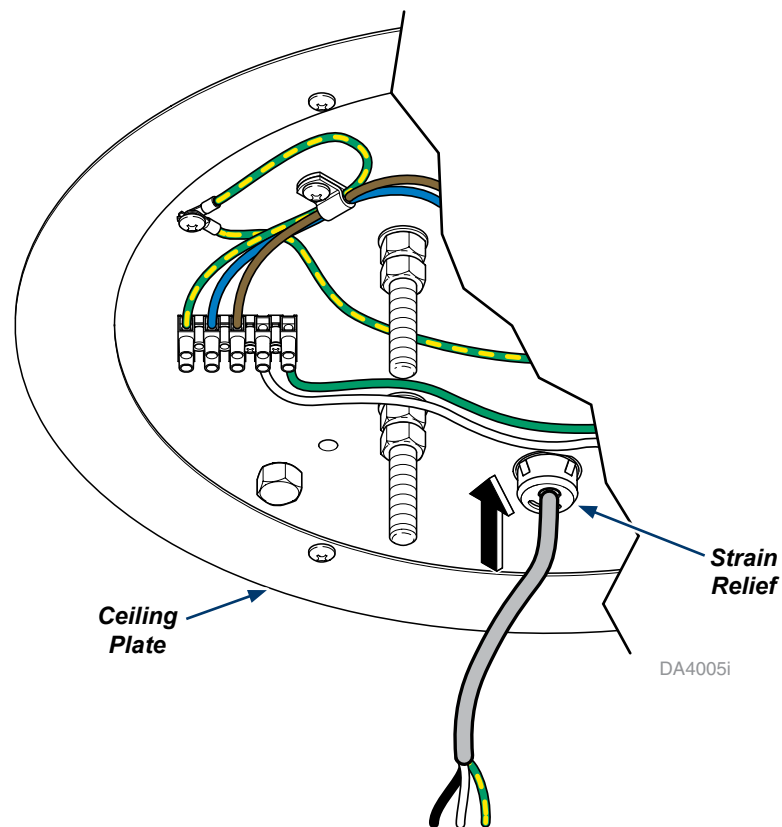

LIN Installation (Ceiling Mounted Lights)

Step 3: LIN connection preparation.

- A) If necessary to run wiring use 30 foot cable provided.
- B) Cut off quick disconnects.
- C) Strip approximately 1/4 inch of insulation off both wires.

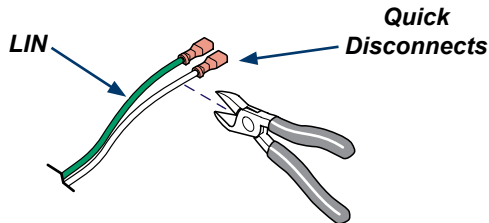

Step 4: Install Strain Relief.

- A) Feed LIN connector and power cord thru both new strain relief (provided) and ceiling plate.
- B) Install strain relief into ceiling plate.

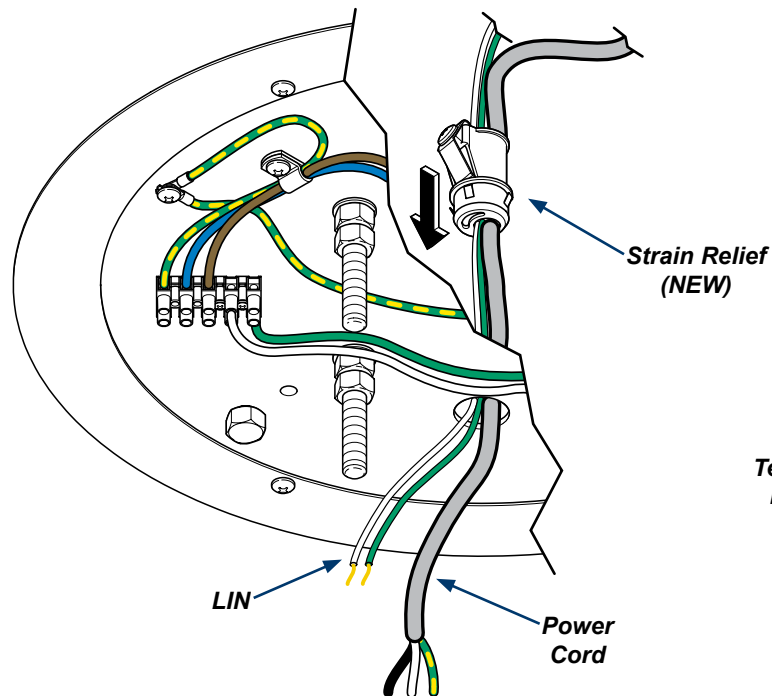

Step 5: Connect Wires.

- A) Insert power cord and LIN connector wires into terminal block as shown.
- B) Tighten terminal block screws.
- C) Install cable clamp to ceiling plate.
- D) Route LIN wires to base of chair as required by facility.
- E) Go to Last Page in this instructions to see LIN connection to Elevance Chair.

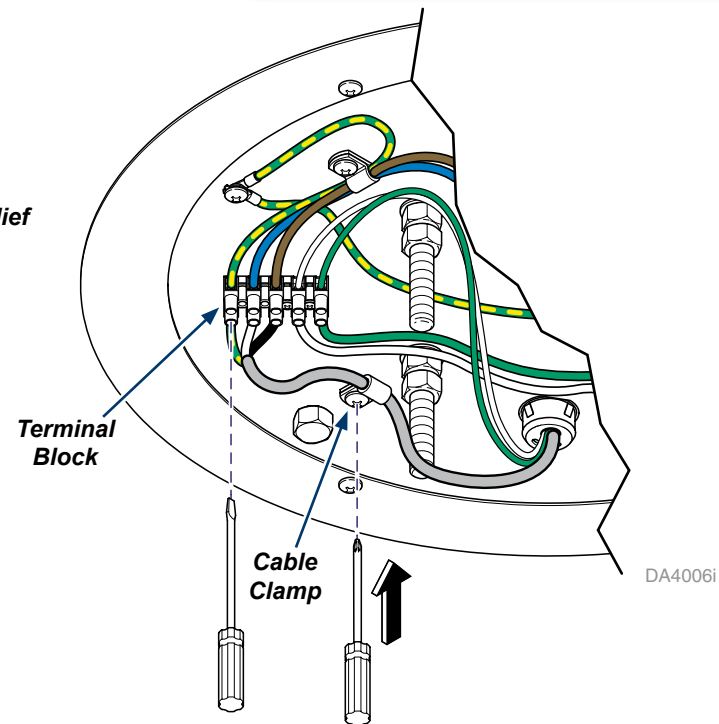

Track Light / Monitor Disconnections

Step 2: Disconnect Power Cord.

- A) Loosen screws on terminal block.
- B) Remove power cord wires from terminal block.

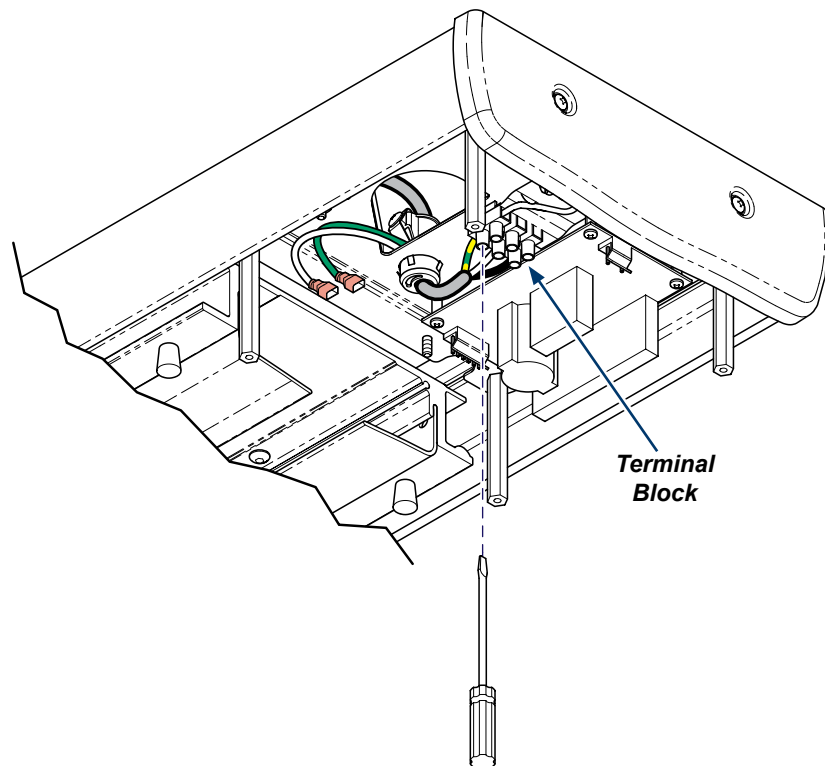

Step 3: Remove Power Cord.

- A) Remove strain relief from mounting plate.
- B) Pull power cord wires thru mounting plate.

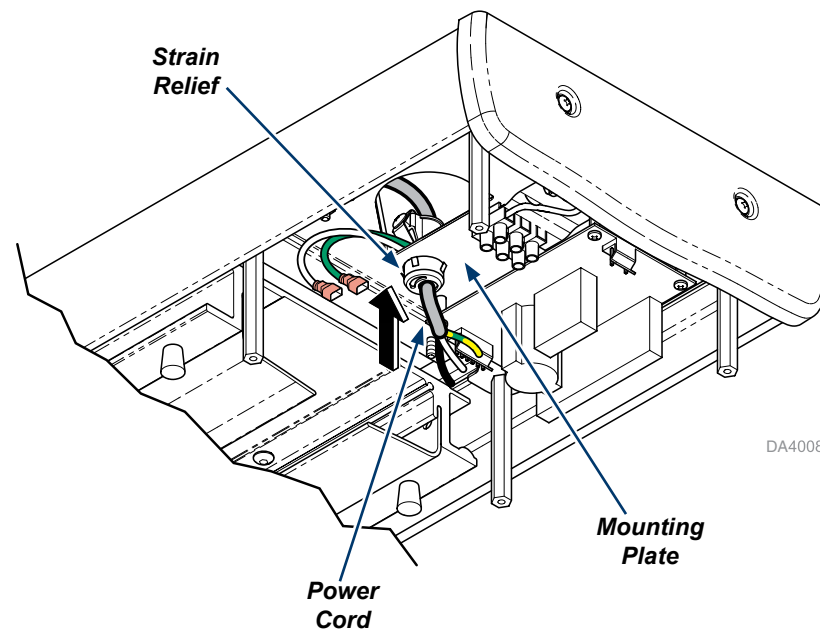

LIN Installation (Track Light / Monitor)

Step 3: Install Strain Relief.

- A) Feed LIN connector and power cord thru both new strain relief (provided) and ceiling plate.
- B) Install strain relief into ceiling plate.
- C) Connect LIN wires to quick disconnects.

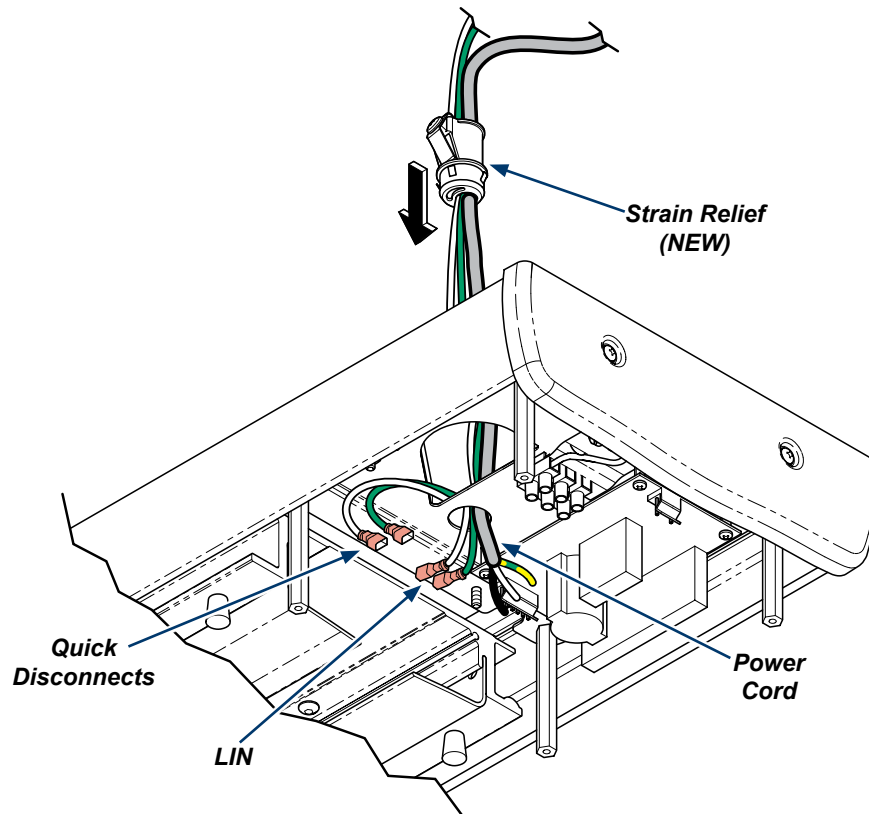

Step 4: Connect Wires.

- A) Insert power cord wires into terminal block as shown.
- B) Tighten terminal block screws.
- C) Route LIN wires to base of chair as required by facility.
- D) Go to Last Page in this instructions to see LIN connection to Elevance Chair.

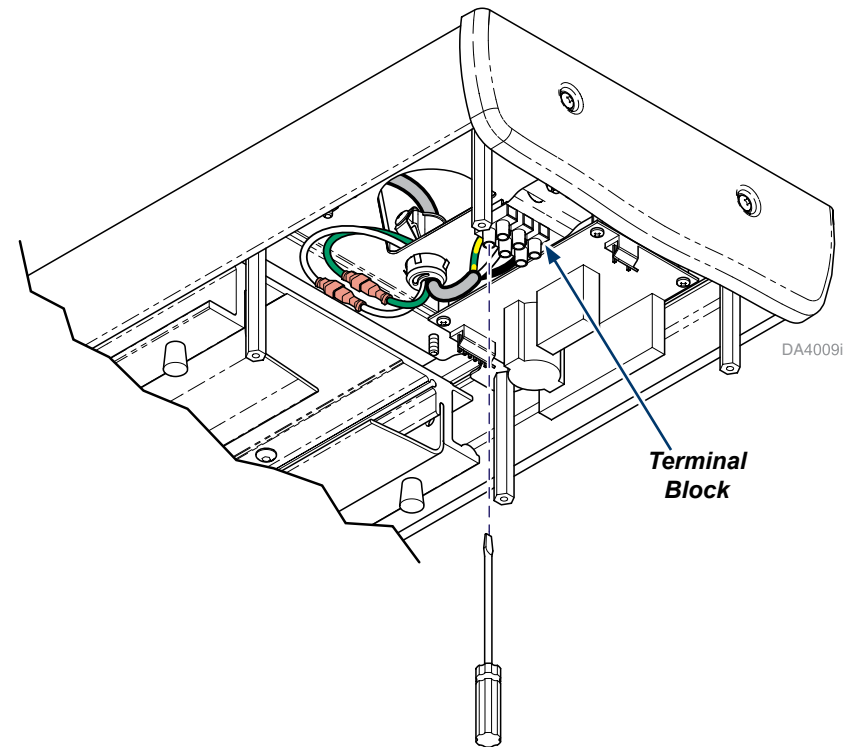

Wall / Cabinet Light Disconnections

Step 2: Remove Hole Plug.

- A) Remove hole plug from bottom cover.
- B) It is not necessary to replace bottom cover if hole plug exists.

Note: Refer to LIN Installation steps after removing Hole Plug.

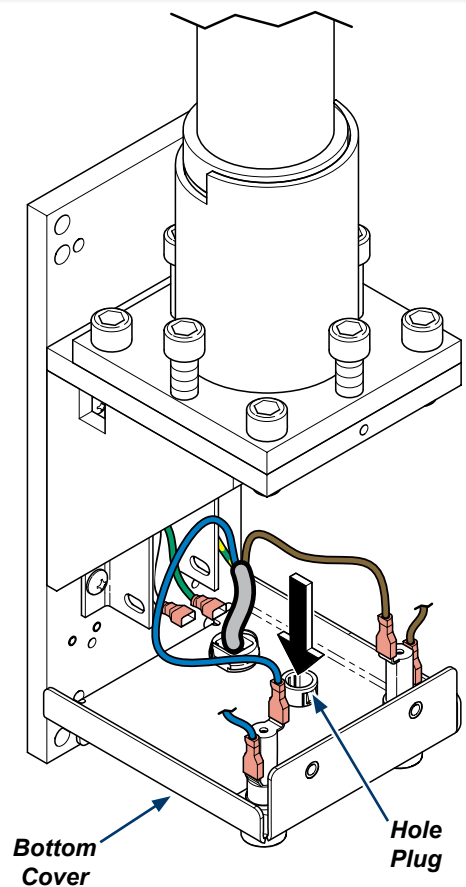

Step 3: Replace bottom cover (if necessary).

- A) Disconnect transform wires from fuse holders.
- B) Disconnect power cord wires.

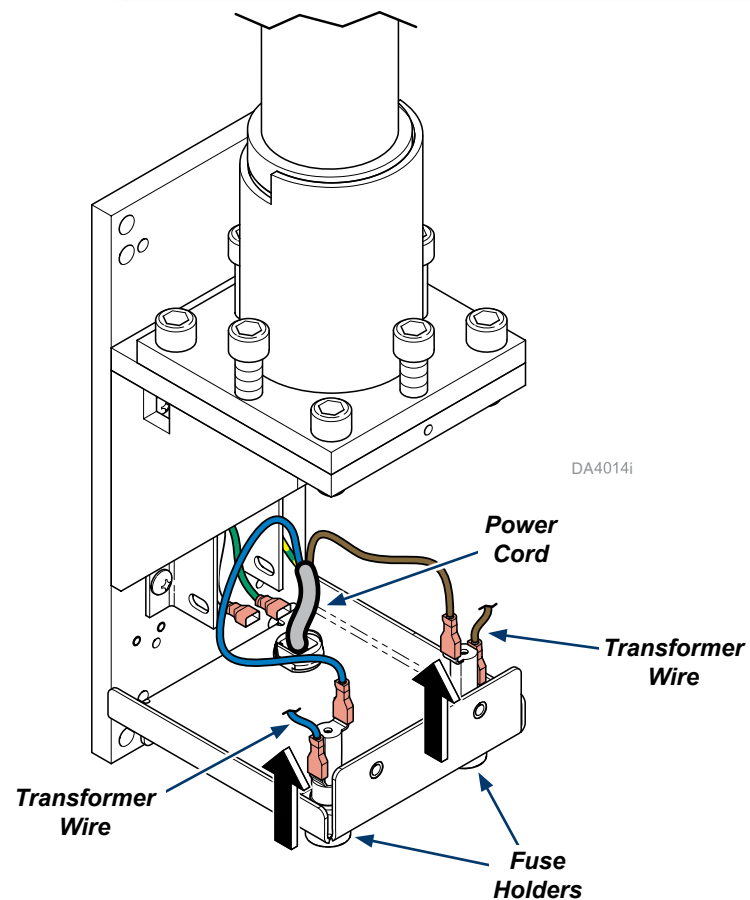

Wall / Cabinet Light Disconnections

Step 4: Remove Bottom Cover.

- A) Remove two screws and washers (save) from bottom cover.

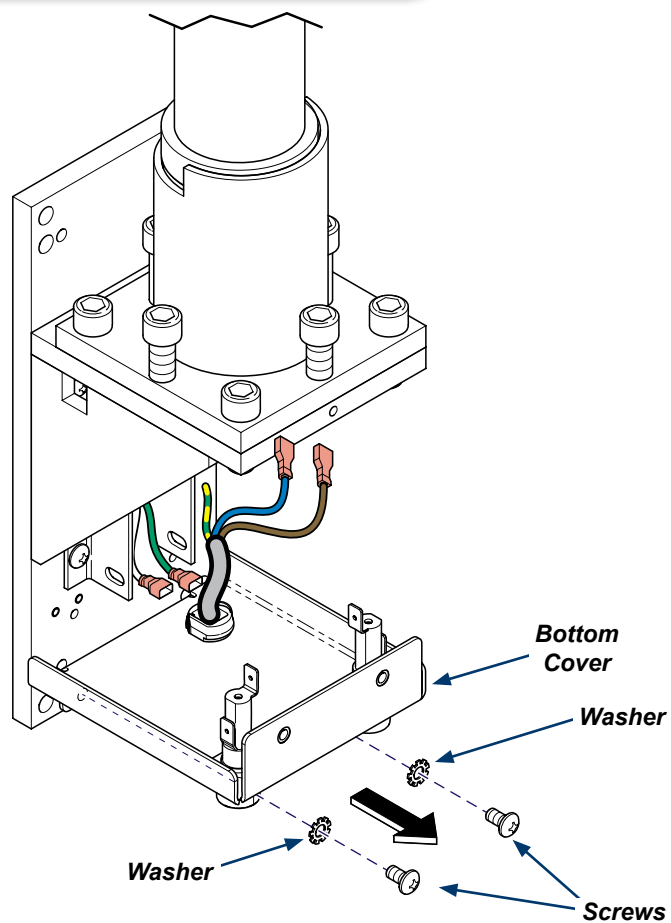

Step 5: Assemble NEW Bottom Cover.

- A) Remove fuse holders and power cord with strain relief.
B) Assemble fuse holders and power cord with strain relief into new bottom cover (provided).

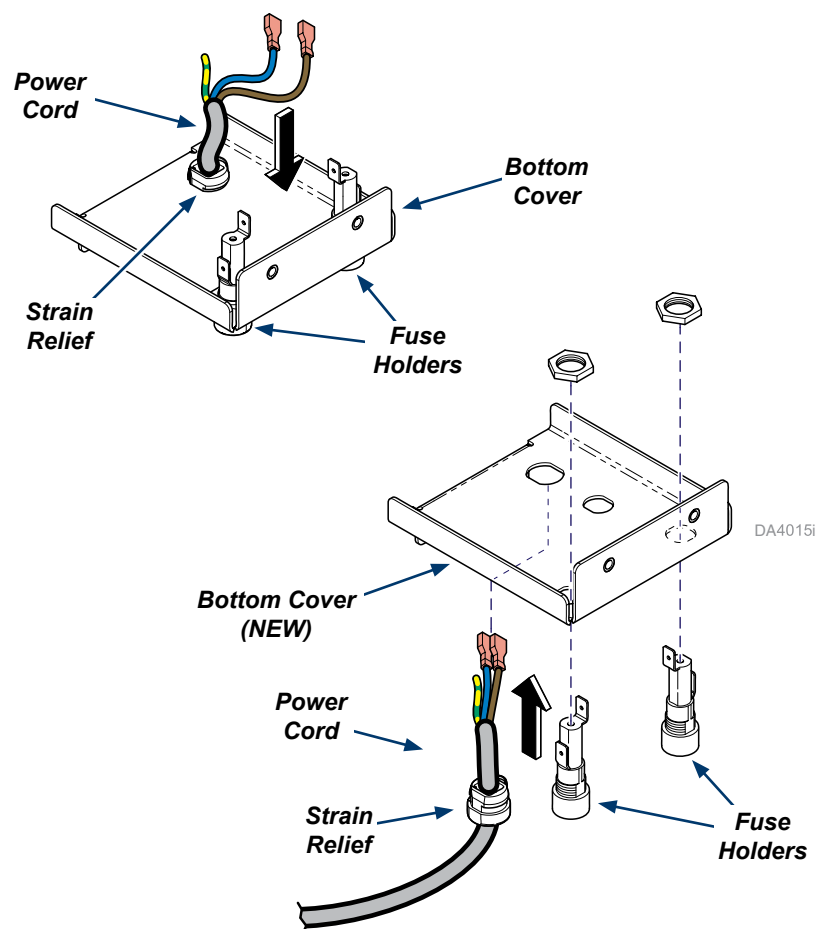

Wall / Cabinet Light Disconnections

Step 6: Install NEW Bottom Cover.

A) Install new bottom cover using two screws and washers into wall plate.

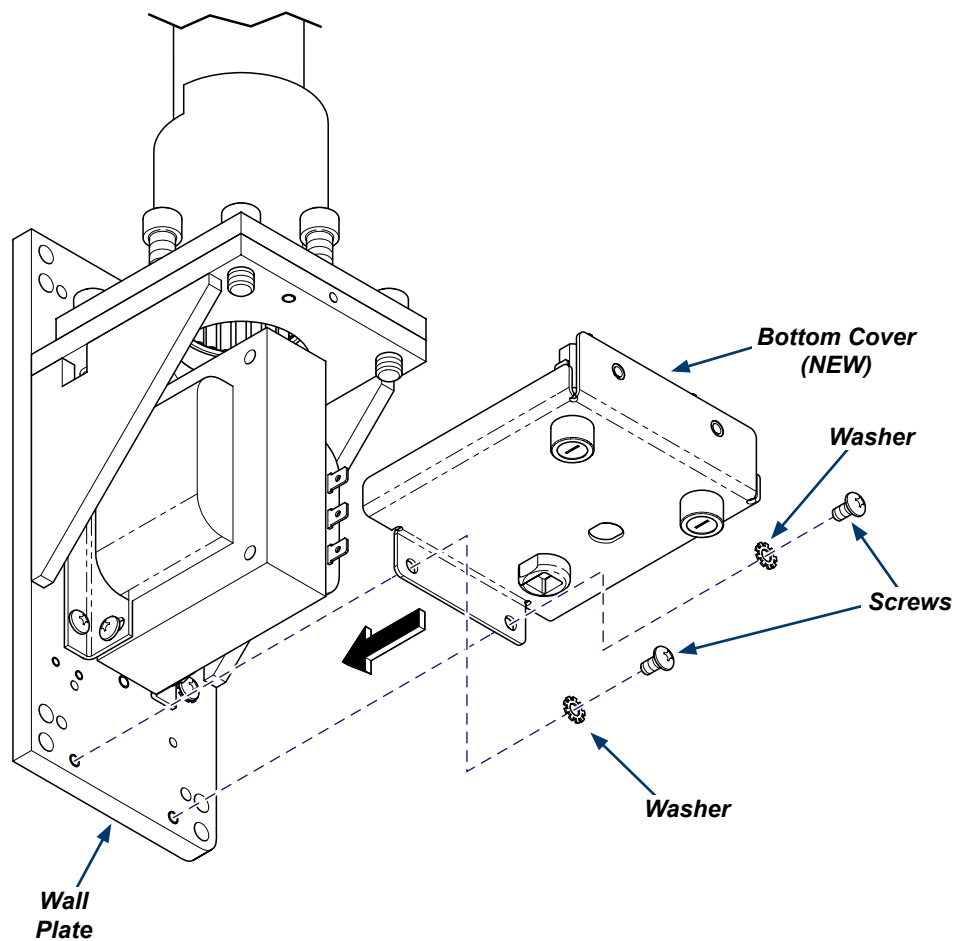

Step 7: Connect Wiring.

A) Connect transform wires to fuse holders.
B) Connect power cord wires.

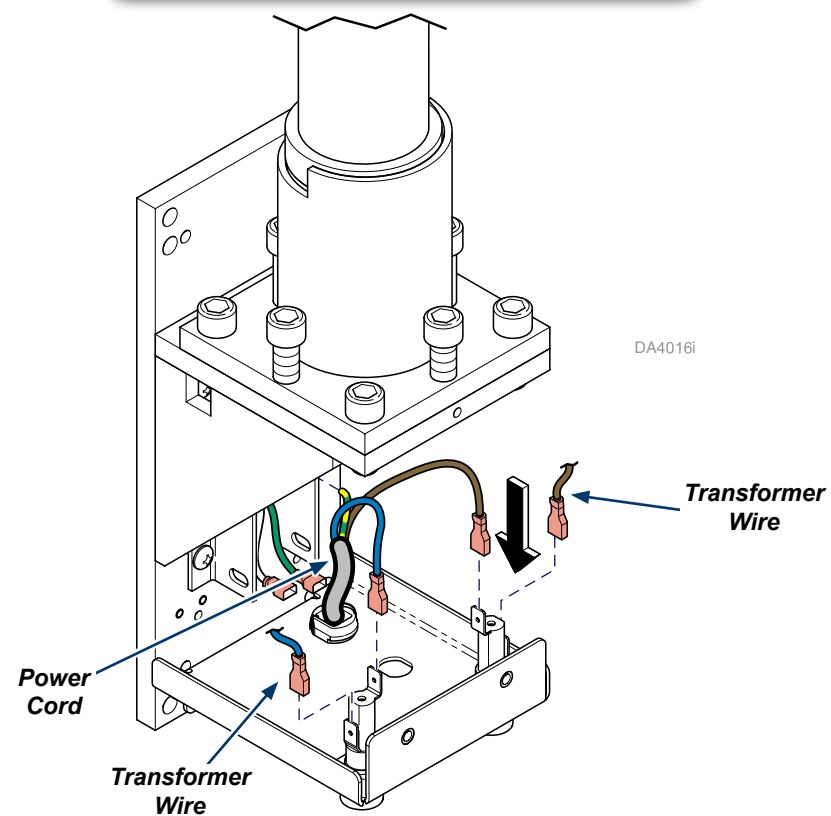

LIN Installation (Wall / Cabinet Lights)

Step 9: Install Strain Relief.

- A) Feed LIN connector thru strain relief (provided) and bottom cover.
- B) Install strain relief into bottom cover.

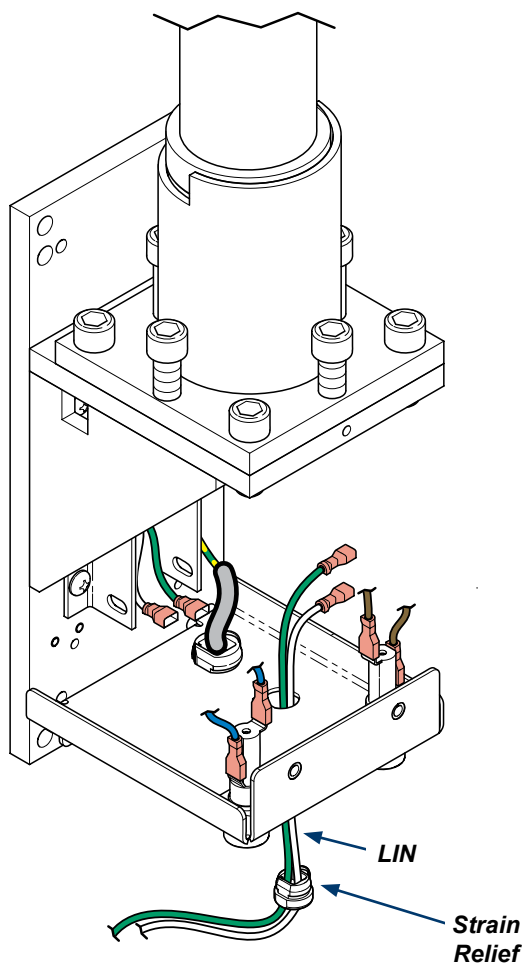

Step 10: Connect Wires.

- A) Connect LIN wires to quick disconnects.
- B) Route LIN wires to base of chair as required by facility.
- C) Go to Last Page in this instructions to see LIN connection to Elevance Chair.

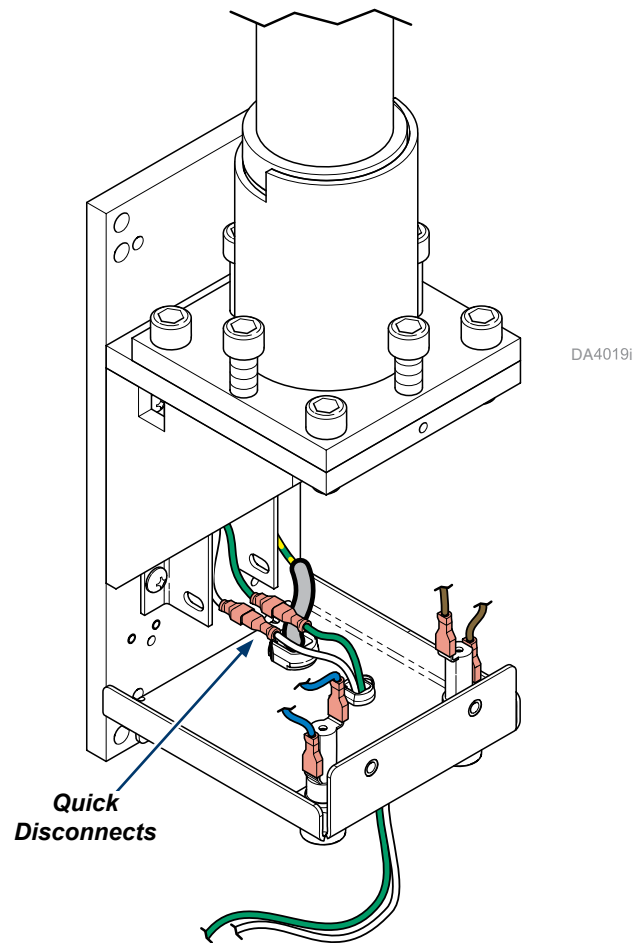

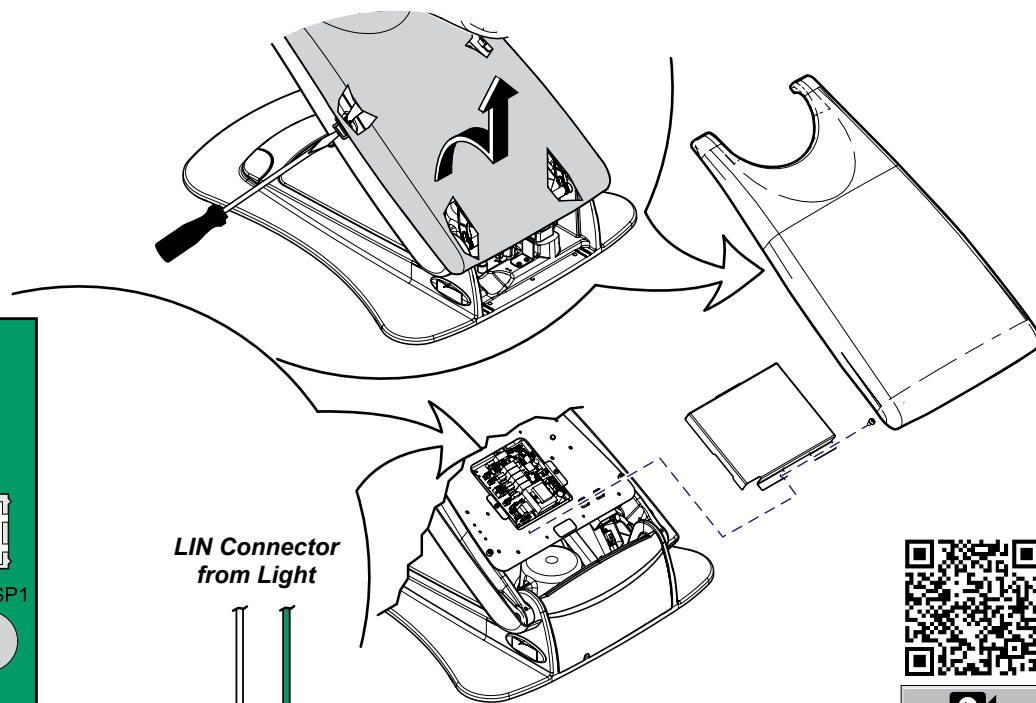
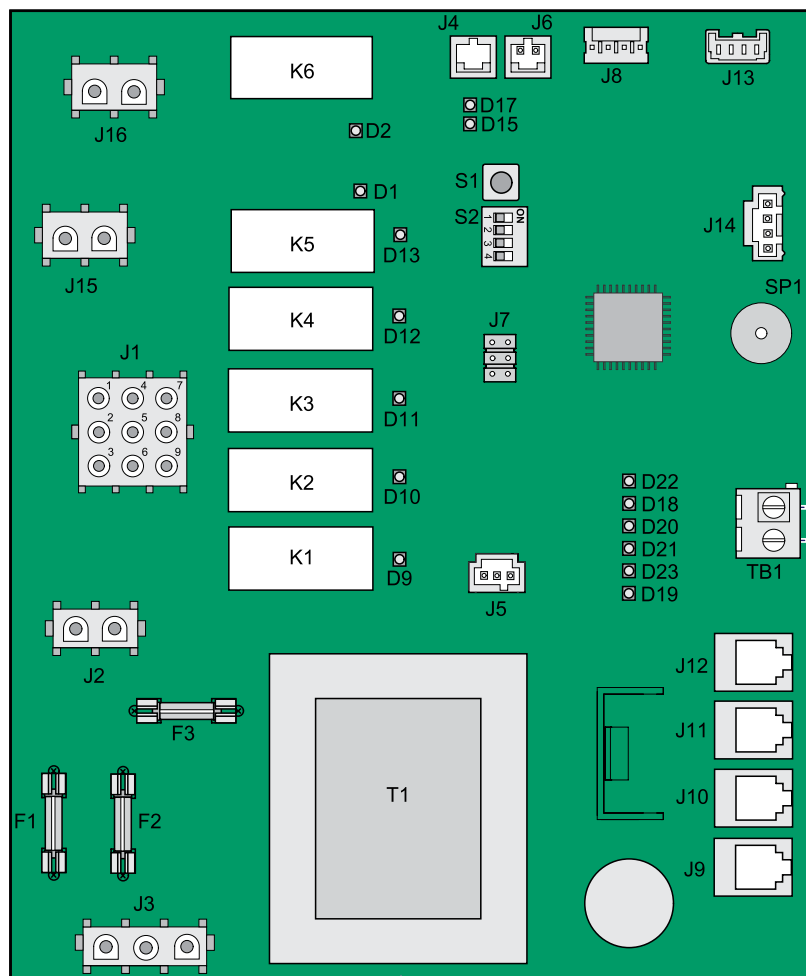

LIN Connector from Light



Step 1: Remove covers.

- Release two clips using a flat head screw driver.
- Pull upper lift arm cover up to free it from shaft.
- Remove two screws and metal PC Board cover.

Step 2: Connect Wires.

- Insert LIN connector wires into terminal block TB1 as shown on PC Board.

DA4020i



Because we care.