



Gas Spring Kit [002-1682-00]

Applies to Models:

222 (-015 thru -017)
622 (-007 thru -008)

Special Tools:

none

Language of origin: English



Equipment Alert

Use top cover supplied in kit to assure proper operating clearance.

Note

Remove all accessories (ex. chair arms) before performing this procedure.



Equipment Alert

Remove cladding. (Midmark models only)

Step 1: Remove screw(s) from drawer slides.

Note: Tables w/o drawer heater do not have screws.

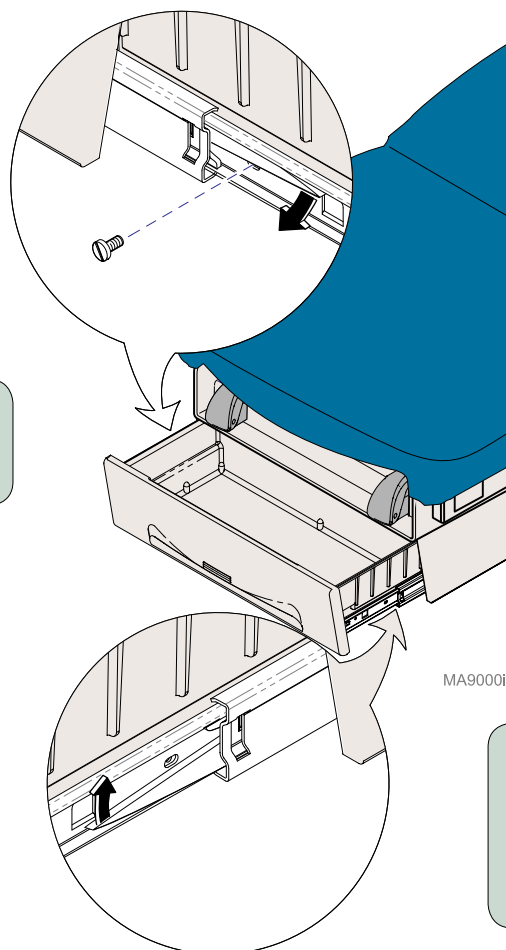

Step 2: Remove drawer.

- A) Push LH side lever UP and RH side lever DOWN.
- B) Remove drawer.

Note: Side levers are clear plastic.

Note

If necessary, remove receptacle cover for better access to LH inside screw.

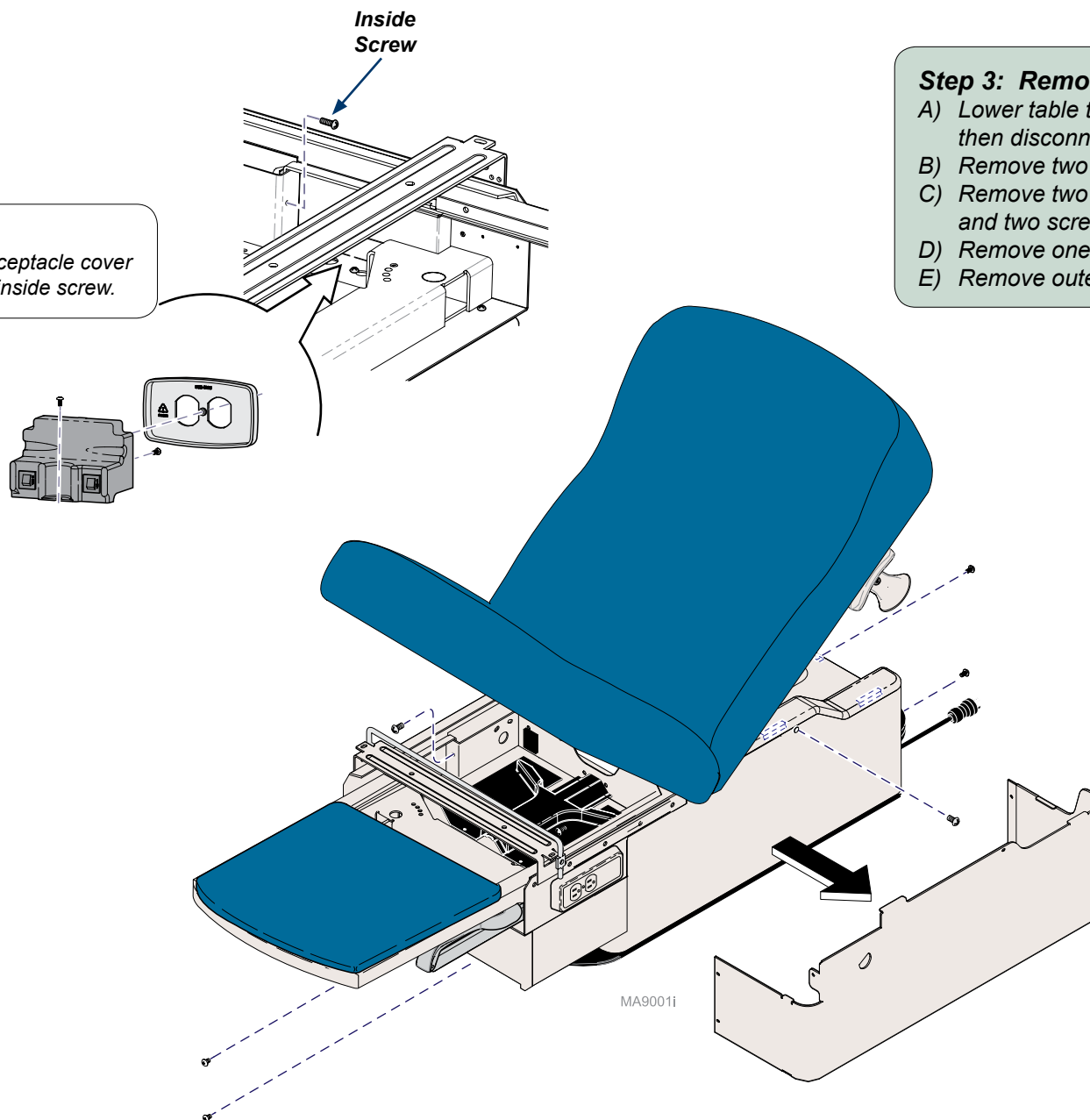
**Step 3: Remove outer shrouds.**

- A) Lower table to the lowest height, then disconnect power cord.
- B) Remove two inside screws.
- C) Remove two screws from head end and two screws from foot end.
- D) Remove one screw from each side.
- E) Remove outer shrouds.

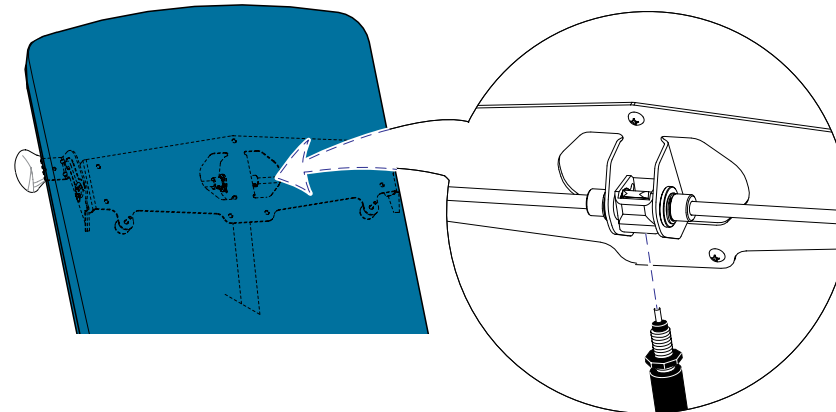
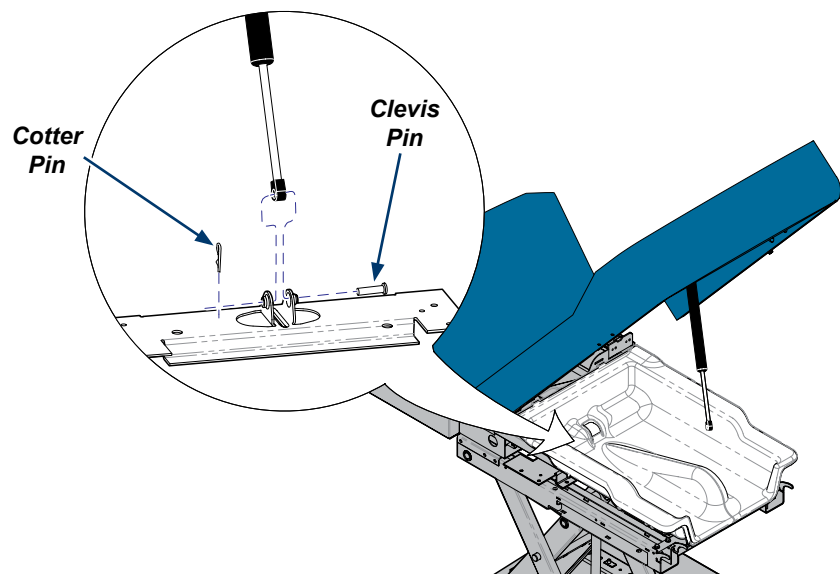

Step 4: Remove gas spring.

- A) Remove cotter pin and clevis pin.
- B) Loosen jam nut and unscrew gas spring.
- C) Remove three screws and top cover.

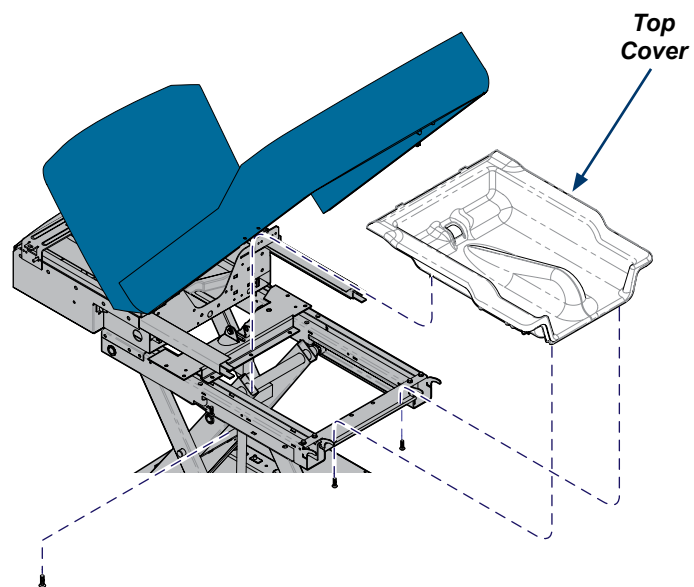

MA9003i

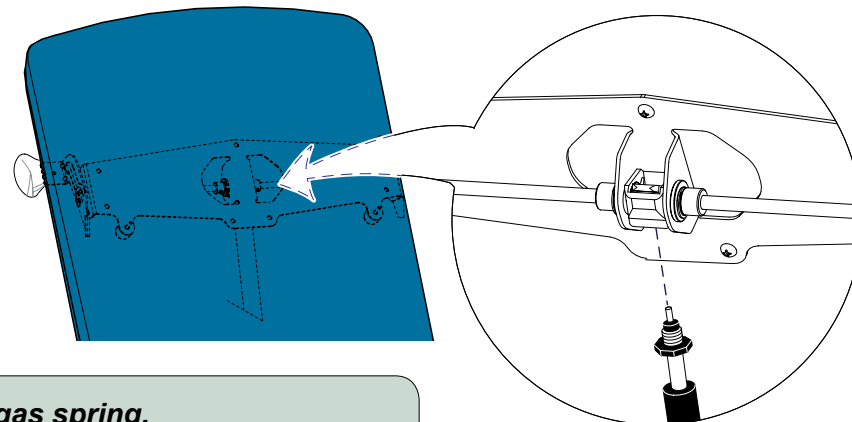
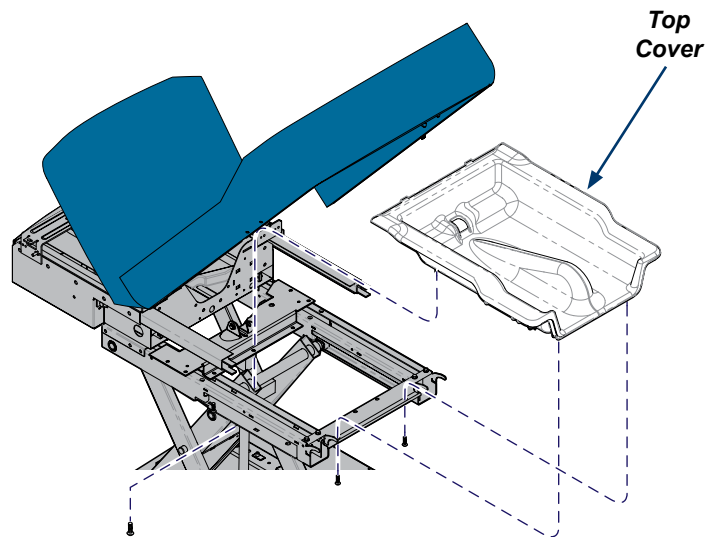

Step 5: Install gas spring.

- A) Install top cover and secure with three screws.
- B) Screw gas spring in 9/16 of an inch from top of plunger to top of jam nut.
- C) Tighten jam nut.
- D) Hold gas spring and squeeze release handle gently to extend shaft.
- E) Secure gas spring with clevis pin and cotter pin.

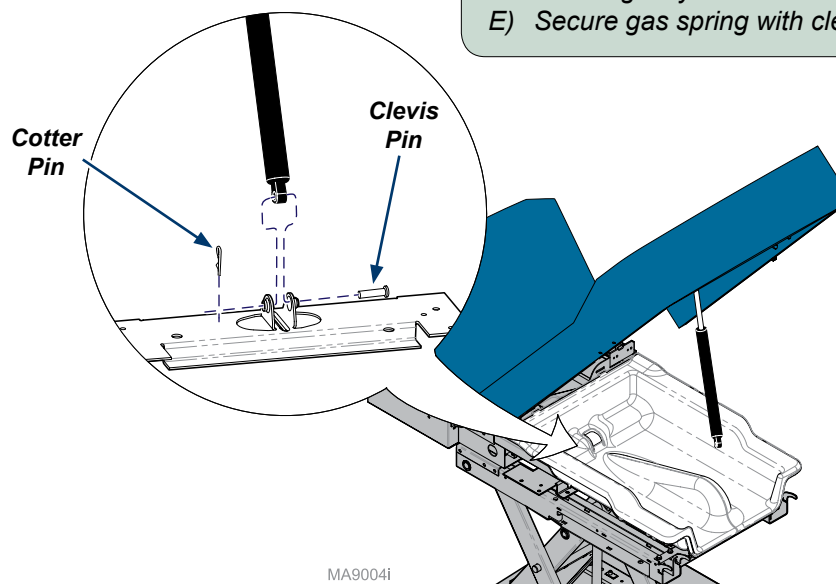

MA9004i

Step 6: Install outer shrouds.

- A) Position outer shrouds.
- B) Install one screw on each side.
- C) Install two screws at head end and two screws at foot end.
- D) Install two inside screws.
- E) Install Drawer.

