

Seat Rail (28") [9A567]

Applies to Models:

630 (-010 through -013)
630 (-020 through -023)
631-001

Language of origin: English

Note

Install seat rails on both sides (one side shown).

630 Models

Step 1: Prepare area.

- Remove top upholstery.
- Adjust tilt angle as needed.



WARNING

Always disconnect chair from power source before removing any covers. Failure to do so may result in personal injury.

Step 2: Remove covers.

- Remove screw from underneath side cover.
- Remove side cover.
- Remove two hole plugs.

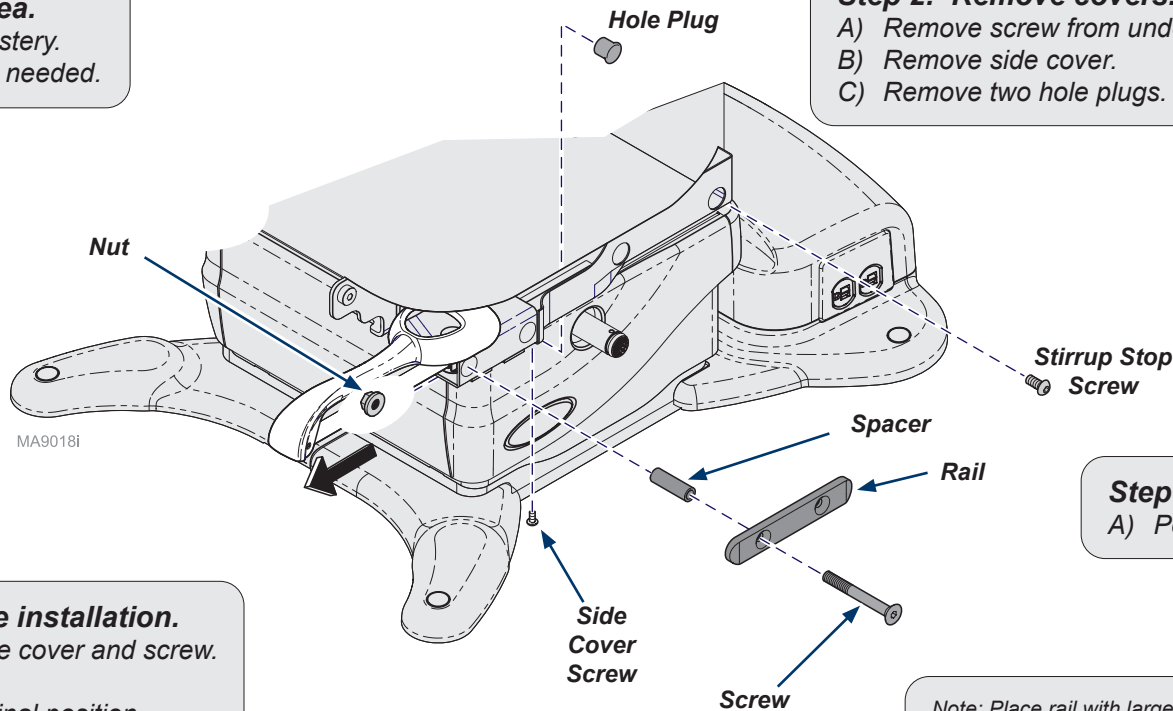

Step 3: Position stirrup.

- Position stirrup for clear access.

Step 6: Complete installation.

- Install plugs, side cover and screw.
- Connect power.
- Adjust tilt to original position.
- Install upholstery.
- Verify operation.

Step 5: Install stirrup.

- Install stirrup assembly.
- Install stirrup stop screw.

Note: Place rail with large hole on outside so screws are flush with rail.

Step 4: Install seat rail.

- Position seat rail and spacers.
- Secure with two screws / nuts.

631-001

Note

Install seat rails on both sides (one side shown).

Step 1: Prepare area.

- A) Remove top upholstery.
- B) Adjust tilt angle as needed.



WARNING

Always disconnect chair from power source before removing any covers. Failure to do so may result in personal injury.

Step 2: Remove covers.

- A) Remove five seat cover screws and seat cover.
- B) Loosen three seat cladding screws and remove seat cladding.
- C) Remove stirrup cap.

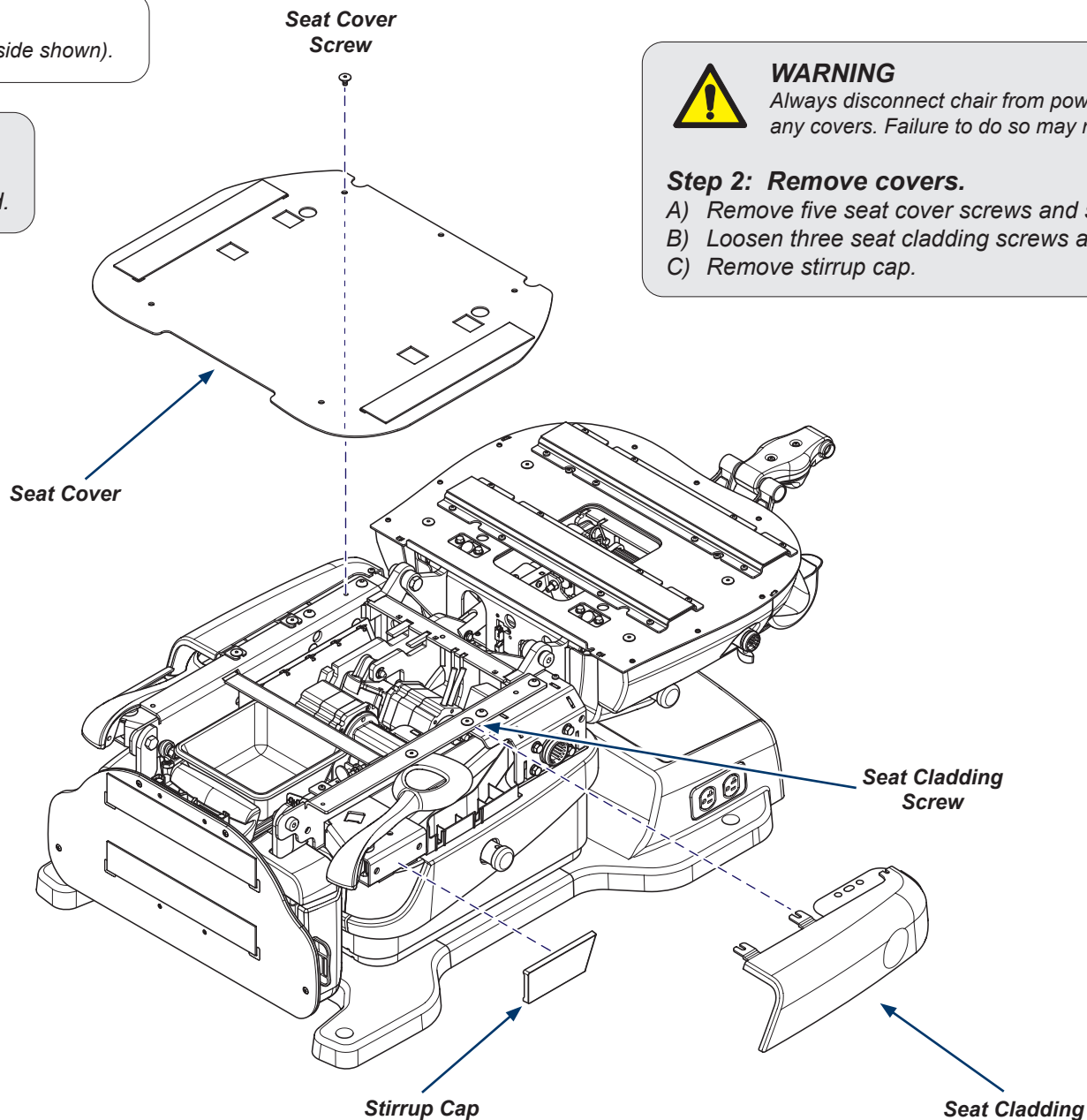

631-001 - continued

Step 3: Position stirrup.

A) Position stirrup for clear access.

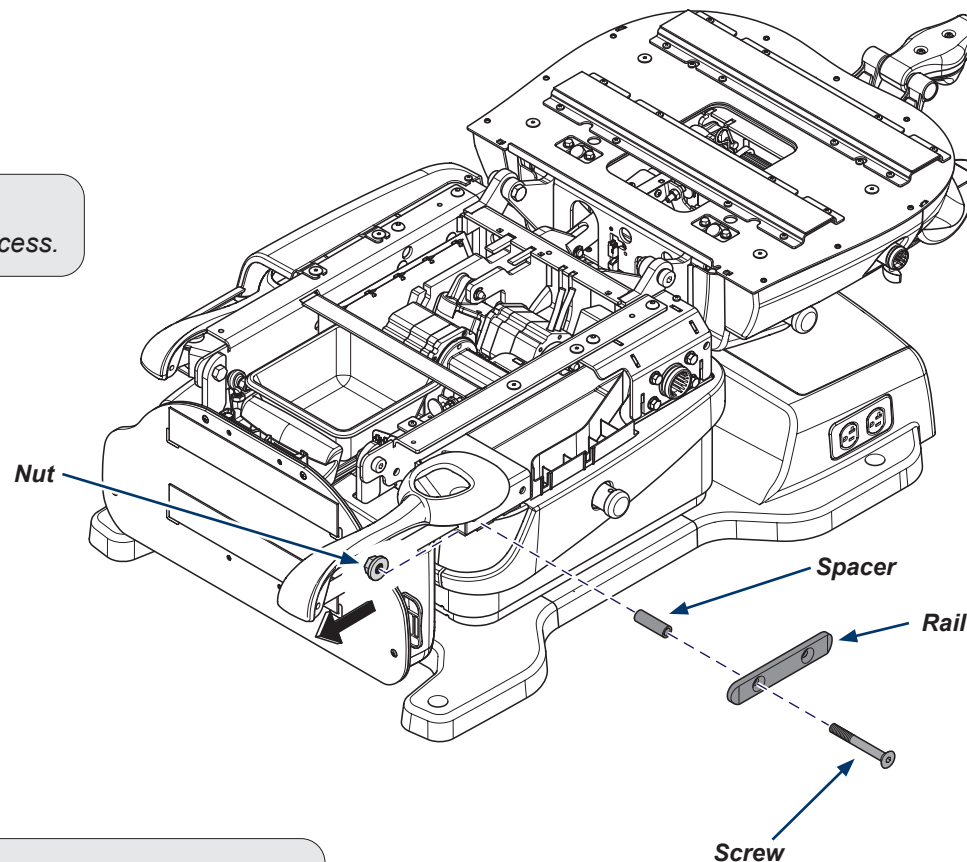

Note: Place rail with large hole on outside so screws are flush with rail.

Step 4: Install seat rail.

A) Position seat rail and spacers.
B) Secure with two screws / nuts.

Step 5: Complete installation.

A) Install covers.
B) Connect power.
C) Adjust tilt to original position.
D) Install upholstery.
E) Verify operation.