

Spline Mount Systems [9A562 / 9A563 / 9A624 / 9A625]

Applies to Models:

630 (-010 thru -013)
630 (-020 thru -023)
631-001

Language of origin: English

Intended Use:

To mount 253 exam light to Midmark® 630 and 631-001.

Note

The spline shaft is keyed.
Rotate spline mount assembly until it slides into socket.

To install spline mount assembly...

Push spline mount assembly into socket until release lever locks into place.

Note: If socket has locking knob or protective cap installed, remove it.

To install light and cord restraint...

- Align light with holes in mounting plate.
- Secure light by installing two screws thru the top holes.
- Position cord restraint, then install two bottom screws.

Before using light:

Remove protective film from lens.

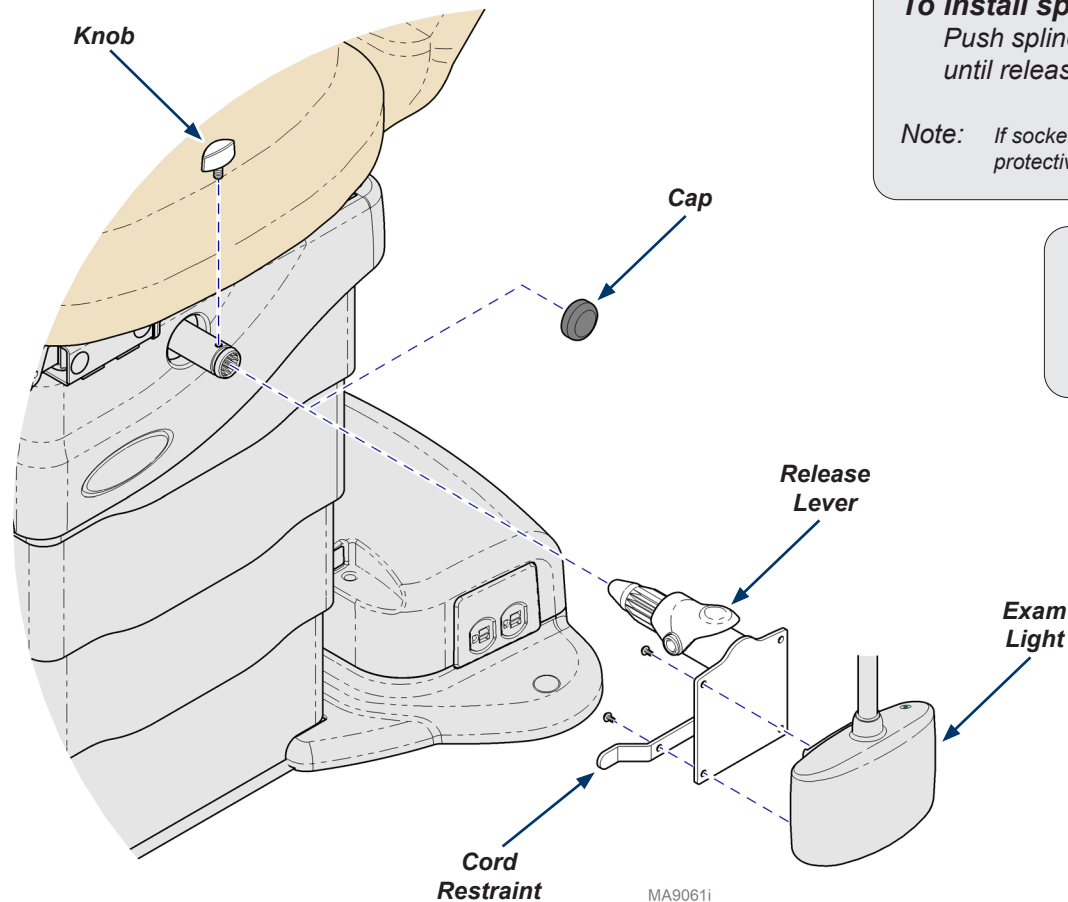

MA9061i

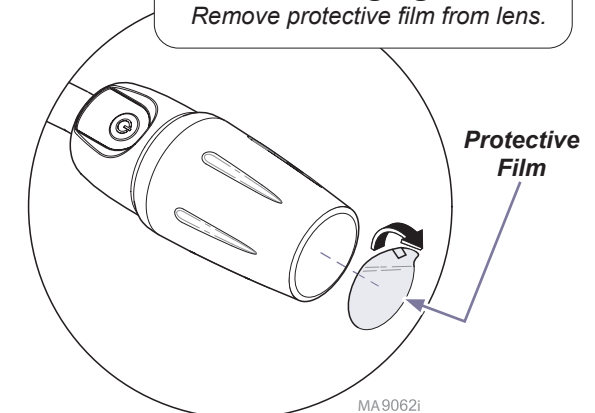

MA9062i