



# PCB w/Photo Interrupter & Pressure Lock Assembly Installation [002-1751-00 (115V) & 002-1751-01 (230V)]

<b>Components:</b>	
PC Board.....	1
Photo Interrupter.....	1
Pressure Interlock Assembly.....	1

## Note

This kit is required for M3 sterilizers having a Serial Numbers prior to V811649.



## Caution

Always disconnect power and allow sterilizer to cool before removing cover.

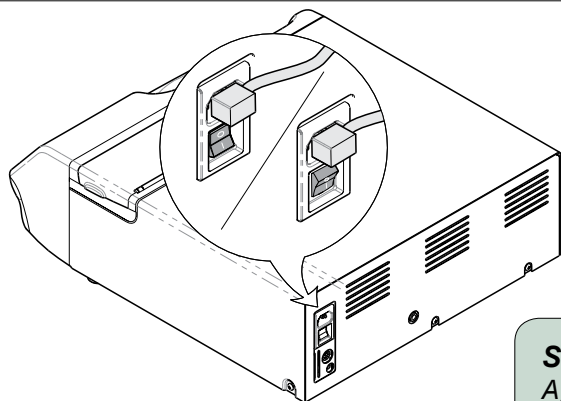

## Step 1: Remove Cover.

- A) Disconnect power to the sterilizer.
- B) Remove screws.
- C) Slide cover back and up to remove.

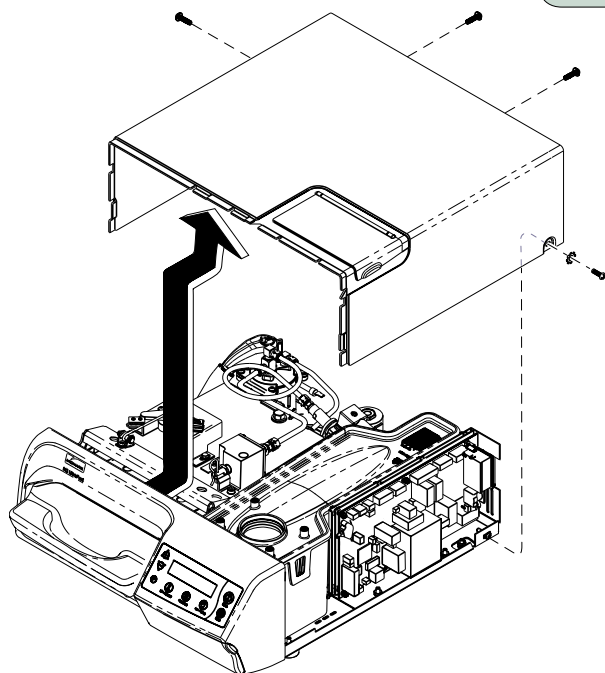

## Step 2: Remove PC Board assembly.

- A) Disconnect all wire connections from PC Board.
- B) Disconnect transducer tube.
- C) Remove two nuts.
- D) Lift PCB assembly straight up to remove.
- E) Repeat this step in reverse to install the new PC Board Assembly.

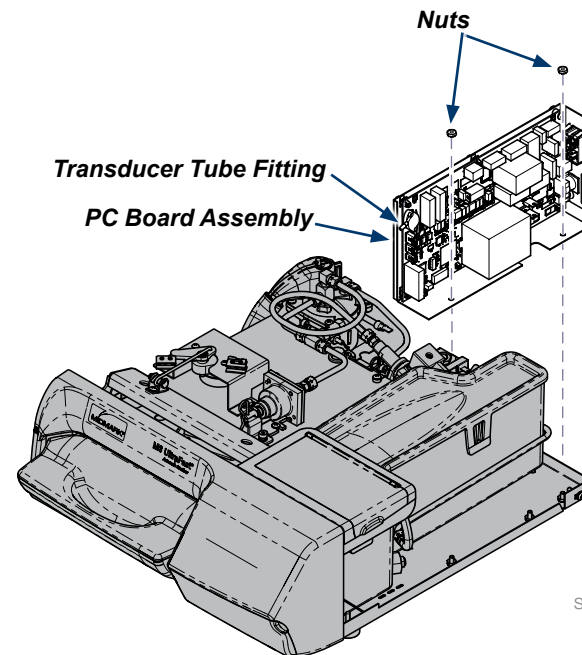

SA1789i

### Step 3: Remove Pressure Interlock Assembly.

- A) Remove cotter pin.
- B) Remove lock bracket and screw.
- C) Disconnect copper tube.
- D) Remove interlock assembly mounting screws.
- E) Lift Interlock assembly straight up to remove.

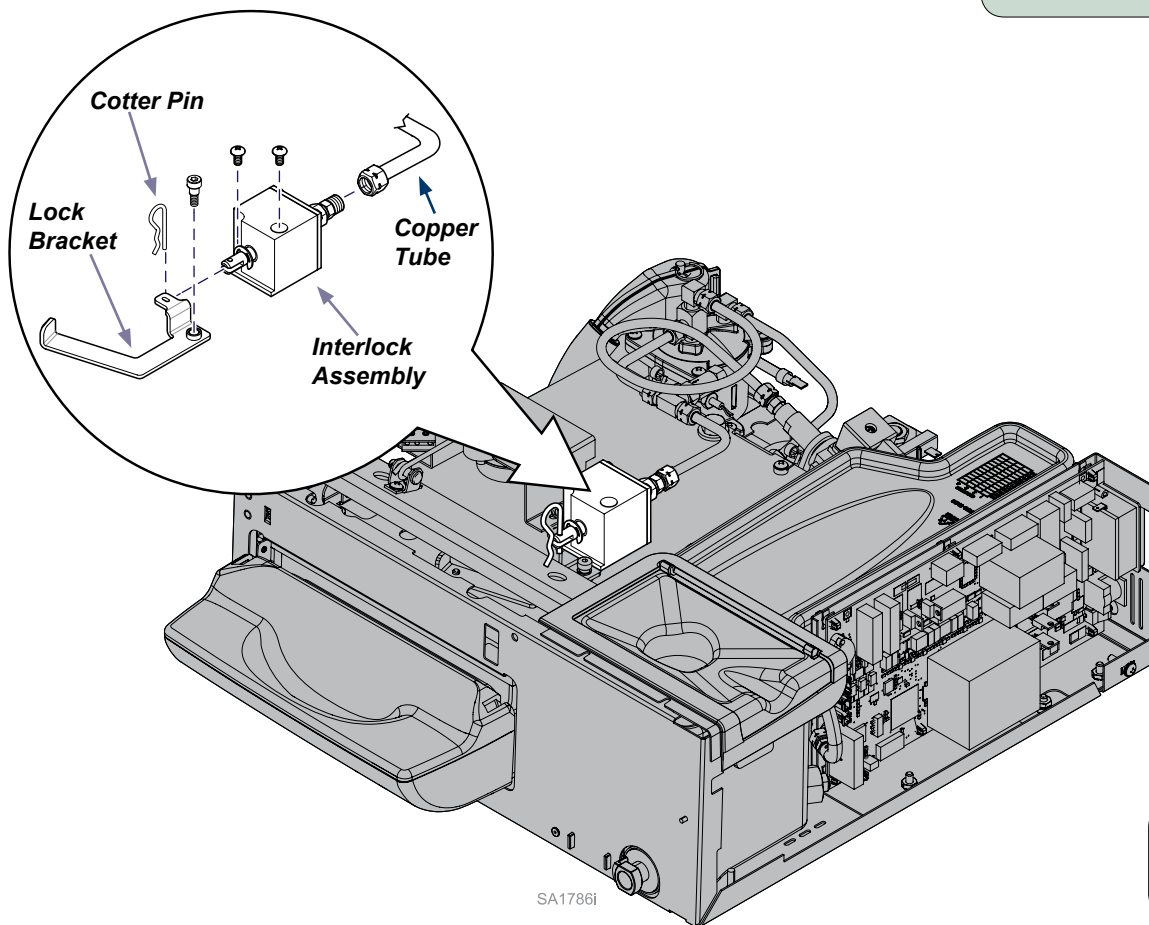

### Step 4: Install Pressure Interlock Assembly with Photo Interrupter.

- A) Install interlock assembly with outside screw.
- B) Install the inside screw through photo interrupter mounting bracket and interlock assembly.
- C) Mount new lock bracket with shoulder screw. Center lock bracket tab into photo interrupter and aligned in groove on interlock assembly.
- D) Install cotter pin.
- E) Connect copper tube to interlock assembly.
- F) Connect photo interrupter wires to J12 on the PC Board.

### Pressure Interlock with Photo Interrupter

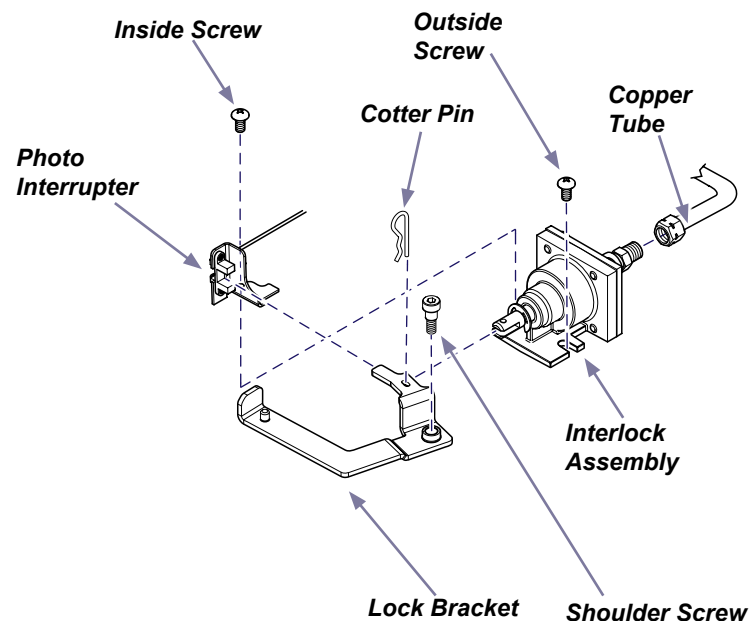

### Step 5: Install Cover and Connect Power.

- A) Reference Step 1.