

Pan Holder Assembly [002-1760-0x]

Applies to Models:

630 (-010 thru -013)
630 (-020 thru -023)
631-001

Special Tools:

none

Language of origin: English



WARNING

Always disconnect chair from power source before removing any covers. Failure to do so may result in personal injury.

Note

The 631-001 does not have a seat mounting board.

To remove Pan Holder Assembly...

- Lower Foot section.
- Remove seat / back upholstery.
- Remove screws, seat mounting board and seat cover plate.
- Remove four mounting screws from pan slides.
- Remove pan holder assembly.

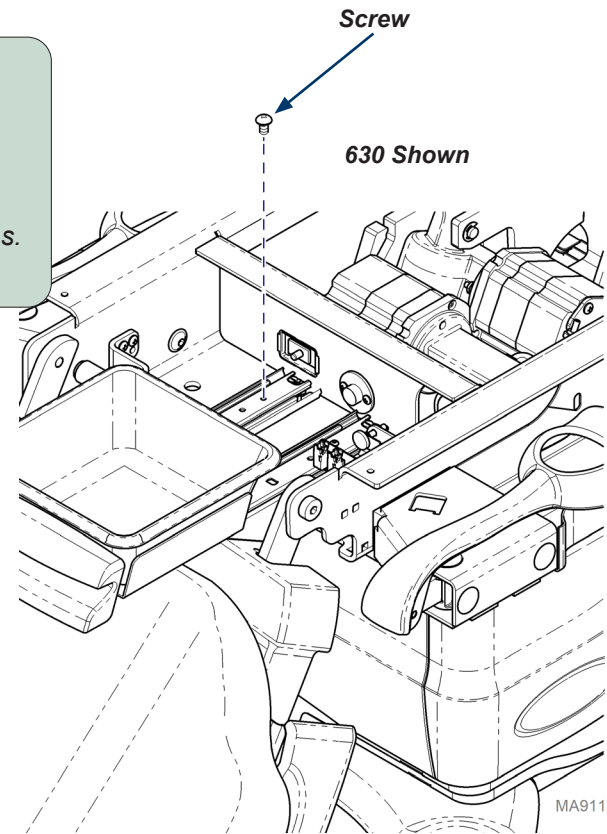
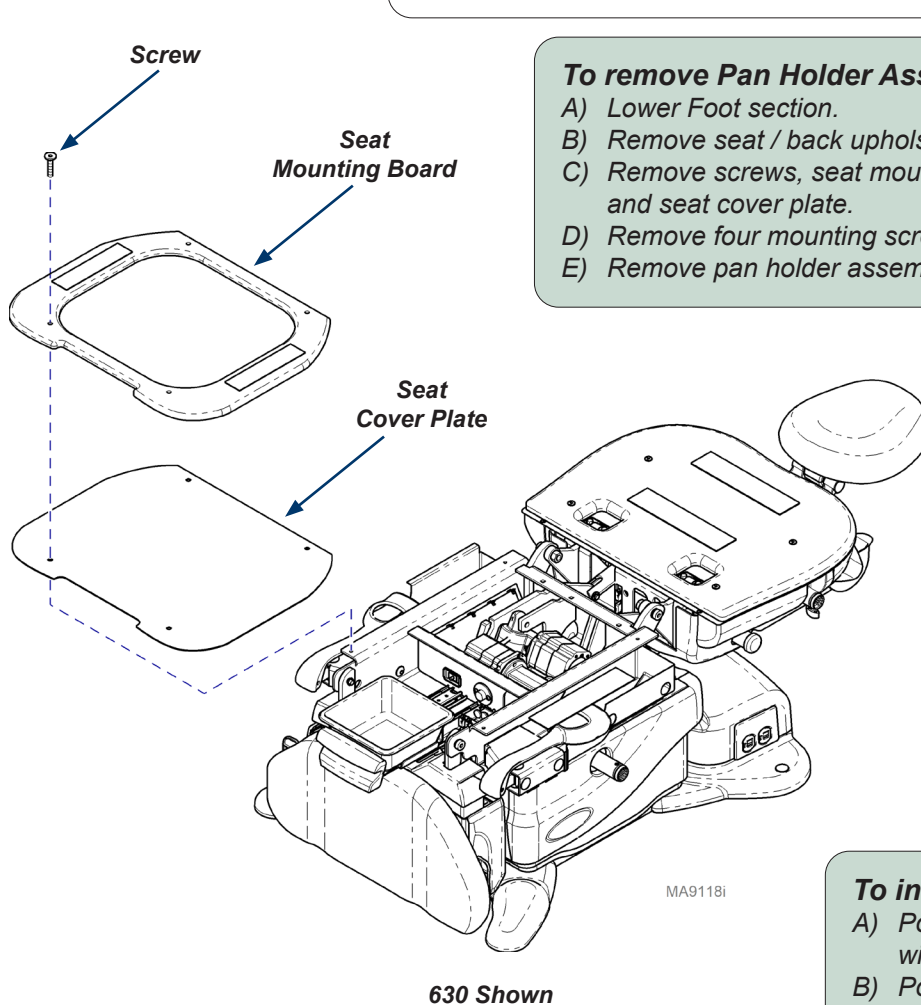

To install Pan Holder Assembly...

- Position pan holder assembly, and secure with four mounting screws.
- Position seat cover plate, and seat mounting board, then secure with screws.

630 Models

To install seat / back upholstery...

- A) Position back section of chair flat.
- B) Position front of seat section against seat mounting board.
- C) Press seat section down firmly.
- D) Position top of back section against the top of the back mounting board.
- E) Check for a consistent gap between seat and back sections.
- F) Press back section down firmly.

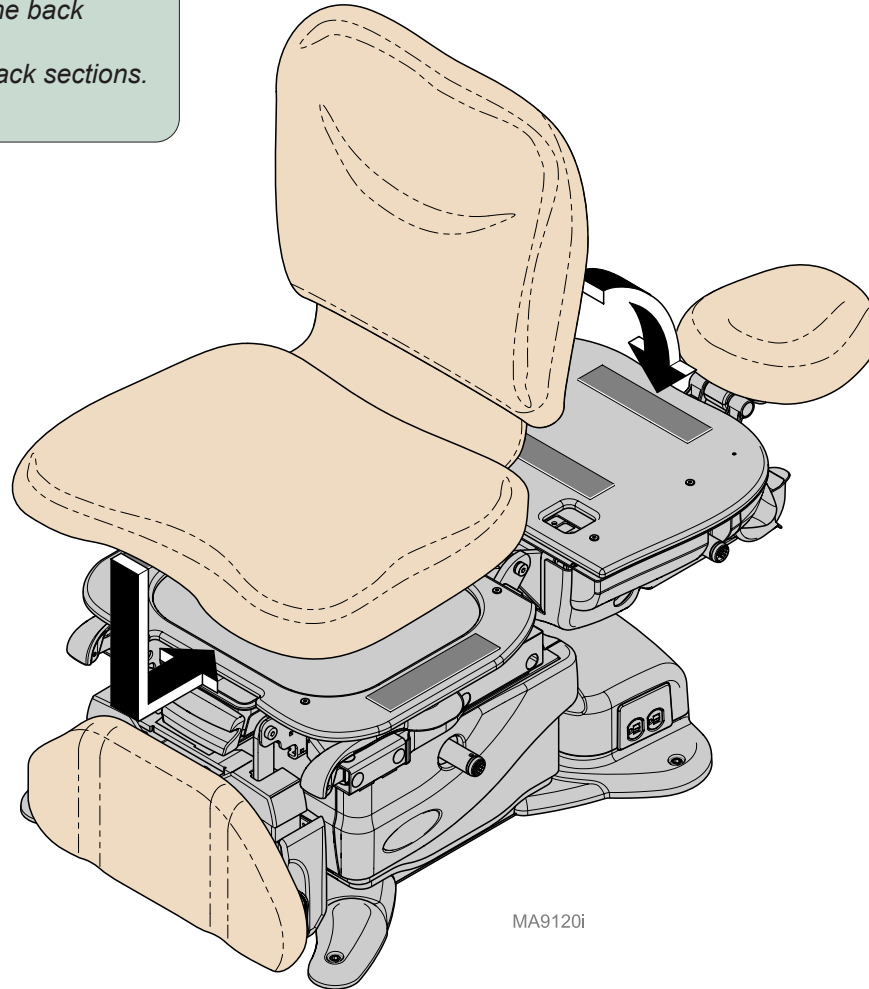

MA9120i

To install seat / back upholstery...

- A) Place the seat section on the chair insuring that the front is up against the seat plate and centered.
- B) Press on seat section firmly to secure.
- C) Raise back section fully up to engage the upholstery to the top of the back plate.
- D) Press on back section firmly to secure.

