

# Power Supply PC Board [002-1747-00]

## Applies to Models:

630 (-010 thru -013)  
630 (-020 thru -023)

## Special Tools:

none

Language of origin: English



### WARNING

Always disconnect chair from power source before removing any covers. Failure to do so may result in personal injury.

### Step 1: Remove PC Boards...

- Remove base cover.
- Disconnect wiring from PC Boards.
- If equipped, remove wireless basestation.
- Disengage standoffs and carefully separate Machine Control PC Board from Power Supply PC Board.
- Remove Power Supply PC Board.

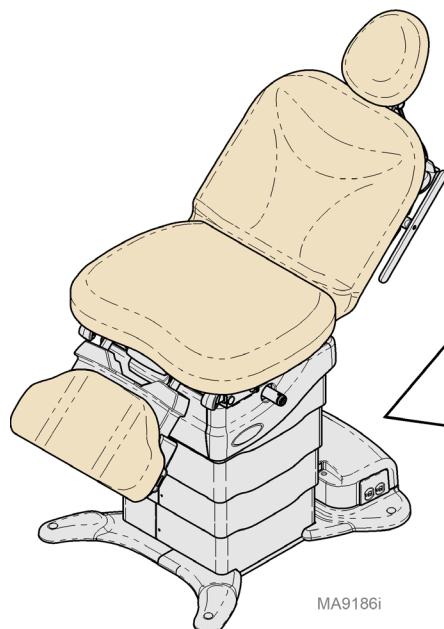

Wireless  
Basestation



### Equipment Alert

Anytime the PC Board is removed or the actuator wires are disconnected, the chair must be calibrated.

Machine Control  
PC Board

Power Supply  
PC Board

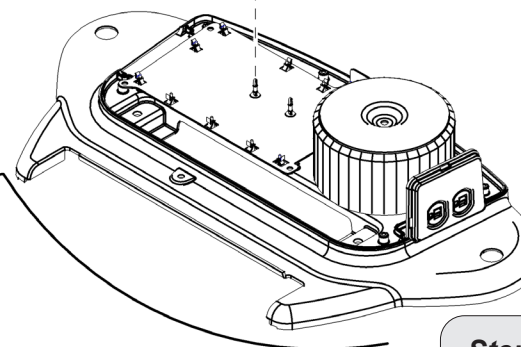

### Step 2: Install PC Boards...

- Install Power Supply PC Board.
- Position Machine Control PC Board, and carefully snap into place.
- If equipped, install wireless basestation.
- Connect wiring to PC Boards.
- Calibrate chair.
- Install base cover.

## Base Cover

### Base Cover Removal / Installation



#### **WARNING**

*Always disconnect chair from power source before removing any covers. Failure to do so may result in personal injury.*

#### **To remove base cover...**

- A) Remove three screws.
- B) Lift cover off of base.

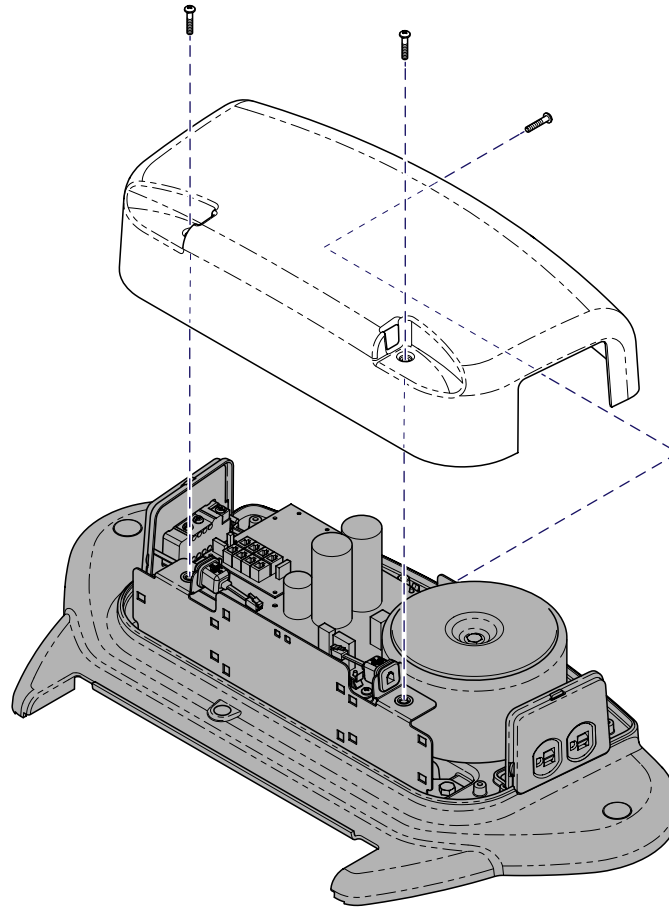

MA9181i

#### **To install base cover...**

- A) Position cover on base.
- B) Secure with three screws.

## Calibration Procedure

During the calibration procedure you will hear a steady pattern of “beeps”.

The chair will run all functions (base, back, tilt, foot) to their minimum and maximum positions, then return to a lowered flat position.

When calibration is complete, the chair will stop moving and you will hear three short “beeps”.

You **must** calibrate the chair in the following situations:

- After replacing Power Supply PC Board.
- After replacing Motor Control Hub PC Board.
- After replacing Machine Control Board.
- After replacing Base, Back, Tilt or Foot actuators.
- After a limit switch bracket is adjusted.
- When an error code indicates calibration is needed.



### Equipment Alert

Anytime the PC Board is removed or the actuator wires are disconnected, the chair must be calibrated.

### Note

When S3 switch is pressed, then released you will hear a steady pattern of “beeps”. When calibration is completed you will hear three short beeps.

### To calibrate...

- Slide foot section to highest stowed position.
- Unplug chair power cord.
- When the digital display darkens, move S2 switch number four to ON (up).
- Plug in chair power cord.
- When the digital display darkens, press and release S3 switch.
- When calibration is complete, unplug chair power cord.
- Move S2 switch number four to OFF (down).
- When the digital display darkens, plug in chair power cord.

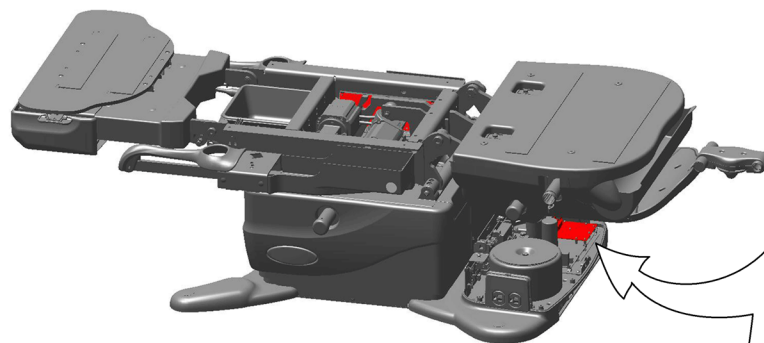

Machine  
Control  
Board

MA9180i

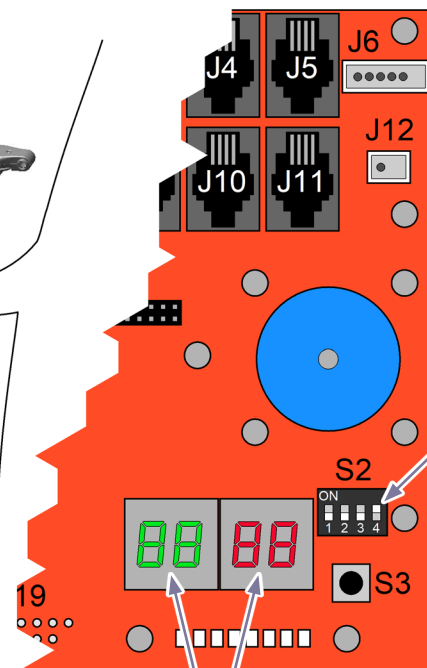

Switch  
Number  
Four

Digital  
Display