

Machine Control PC Board [002-1748-xx]

Applies to Models:

630 (-010 thru -013)
630 (-020 thru -023)

Special Tools:

none

Language of origin: English



WARNING

Always disconnect chair from power source before removing any covers. Failure to do so may result in personal injury.

Step 1: Remove Machine Control PC Board...

- Remove base cover.
- Disconnect wiring from PC Board(s).
- If equipped, remove wireless basestation.
- Disengage standoffs and carefully separate Machine Control PC Board from Power Supply PC Board.

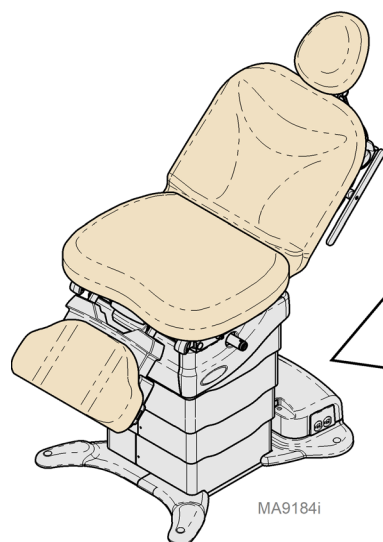

Wireless
Basestation



Equipment Alert

Anytime the PC Board is removed or the actuator wires are disconnected, the chair must be calibrated.

Machine Control
PC Board

Power Supply
PC Board

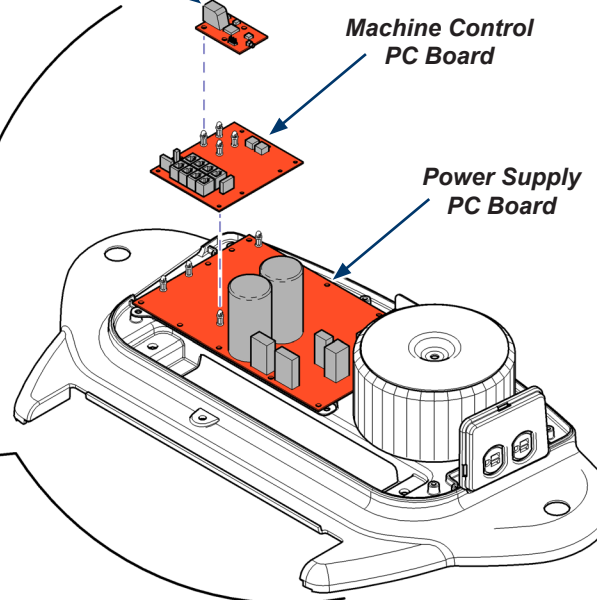

Step 2: Install Machine Control PC Board...

- Position Machine Control PC Board, and carefully snap into place.
- If equipped, install wireless basestation.
- Connect wiring to PC Board(s).
- Calibrate chair.
- Install base cover.

Base Cover

Base Cover Removal / Installation



WARNING

Always disconnect chair from power source before removing any covers. Failure to do so may result in personal injury.

To remove base cover...

- A) Remove three screws.
- B) Lift cover off of base.

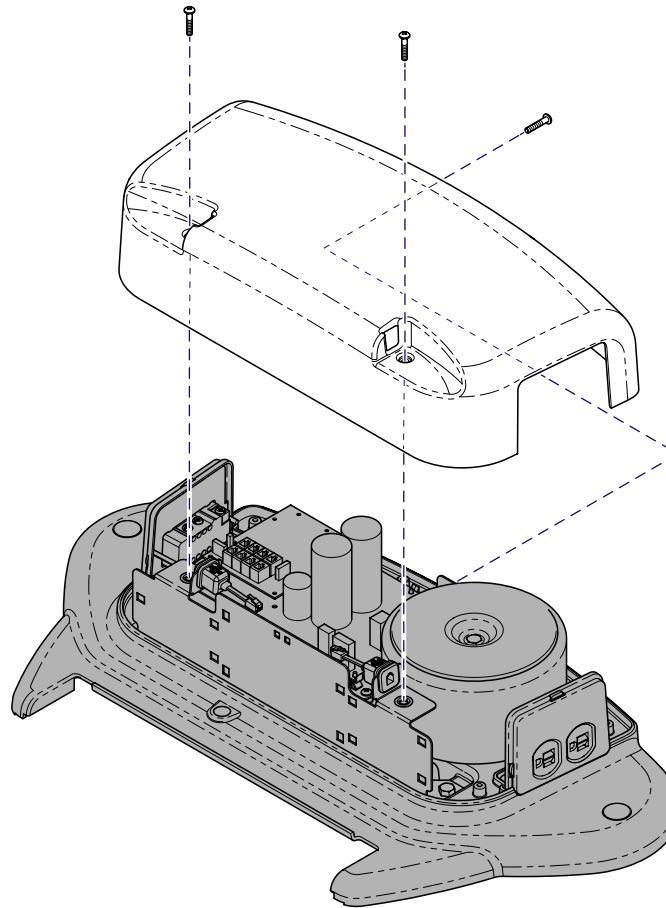

MA9181i

To install base cover...

- A) Position cover on base.
- B) Secure with three screws.

Calibration Procedure

During the calibration procedure you will hear a steady pattern of “beeps” .
The chair will run all functions (base, back, tilt, foot) to their minimum and maximum positions, then return to a lowered flat position.
When calibration is complete, the chair will stop moving and you will hear three short “beeps”.

You **must** calibrate the chair in the following situations:

- After replacing Power Supply PC Board.
- After replacing Motor Control Hub PC Board.
- After replacing Machine Control Board.
- After replacing Base, Back, Tilt or Foot actuators.
- After a limit switch bracket is adjusted.
- When an error code indicates calibration is needed.



Equipment Alert

Anytime the PC Board is removed or the actuator wires are disconnected, the chair must be calibrated.

Note

When S3 switch is pressed, then released you will hear a steady pattern of “beeps”. When calibration is completed you will hear three short beeps.

To calibrate...

- Slide foot section to highest stowed position.
- Unplug chair power cord.
- When the digital display darkens, move S2 switch number four to ON (up).
- Plug in chair power cord.
- When the digital display darkens, press and release S3 switch.
- When calibration is complete, unplug chair power cord.
- Move S2 switch number four to OFF (down).
- When the digital display darkens, plug in chair power cord.

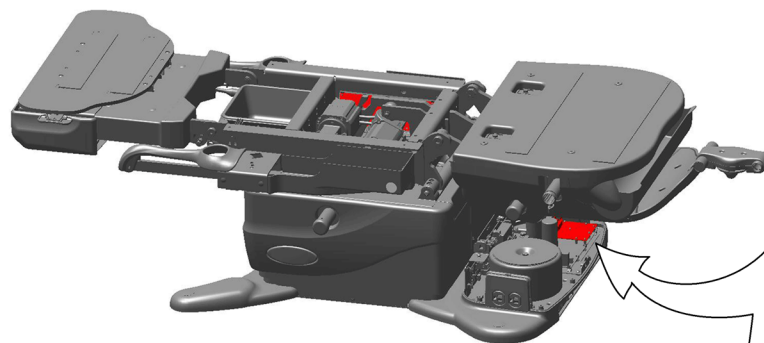

Machine
Control
Board

MA9180i

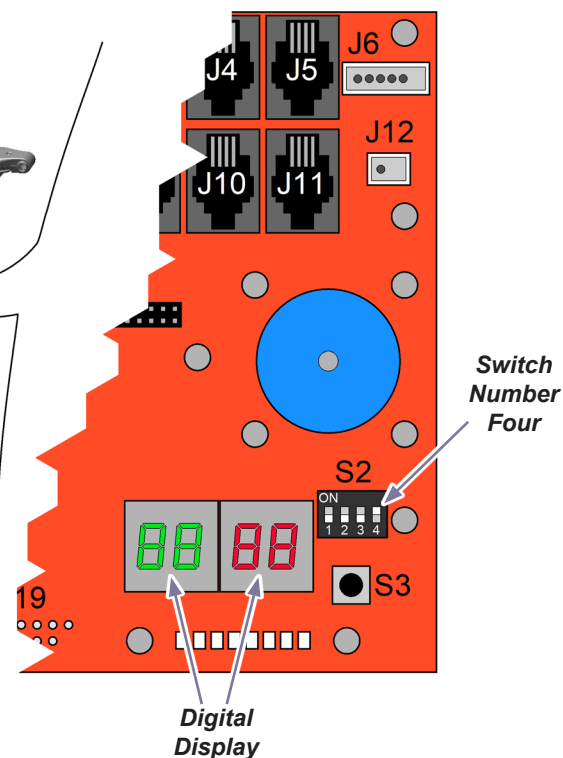

Digital
Display