

Wireless Basestation [002-1766-00]

Applies to Models:

630 (-010 thru -013)
630 (-020 thru -023)

Special Tools:

none

Language of origin: English



WARNING

Always disconnect chair from power source before removing any covers. Failure to do so may result in personal injury.

Step 1: Remove Wireless Basestation...

- Remove base cover.
- Disconnect wiring from wireless basestation.
- Remove wireless basestation.

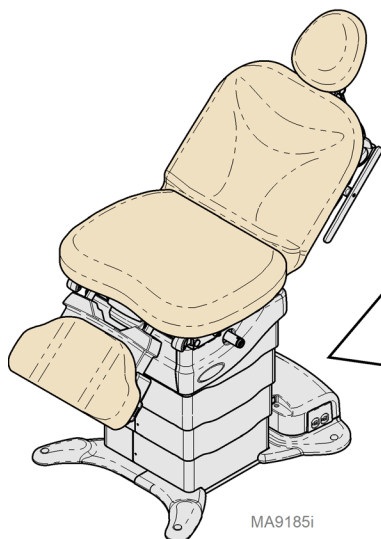

Wireless
Basestation

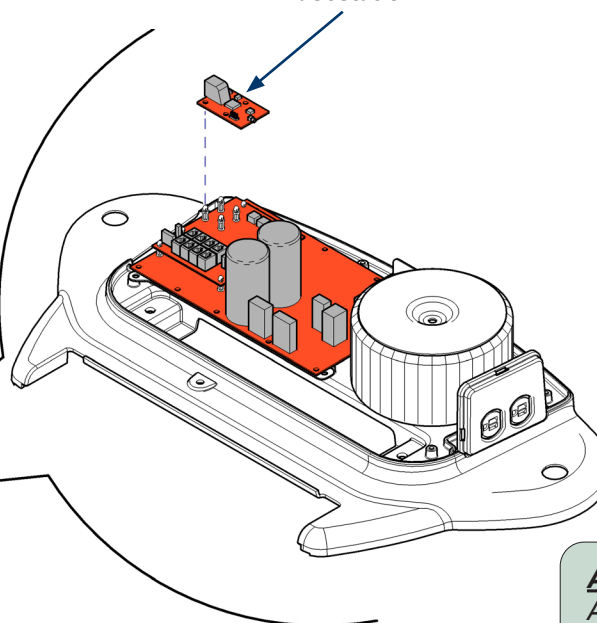

Step 2: Install Wireless Basestation...

- Position wireless basestation, and carefully snap into place.
- Connect wiring to wireless basestation.
- Perform association procedure.
- Install base cover.

Association Procedure:

- Disconnect power to the chair for at least 3 seconds.
- Reconnect power, wait for at least two seconds, then press and hold the **Stop** and **Home** buttons on the **wireless** controller until you hear three "beeps".

** Note: Step B must be performed within 10 seconds of the power up beep sequence from the chair.*

- Check for proper operation of wireless controller.
- If associating a hand **and** foot control, repeat procedure using the other wireless controller.

Base Cover

Base Cover Removal / Installation



WARNING

Always disconnect chair from power source before removing any covers. Failure to do so may result in personal injury.

To remove base cover...

- A) Remove three screws.
- B) Lift cover off of base.

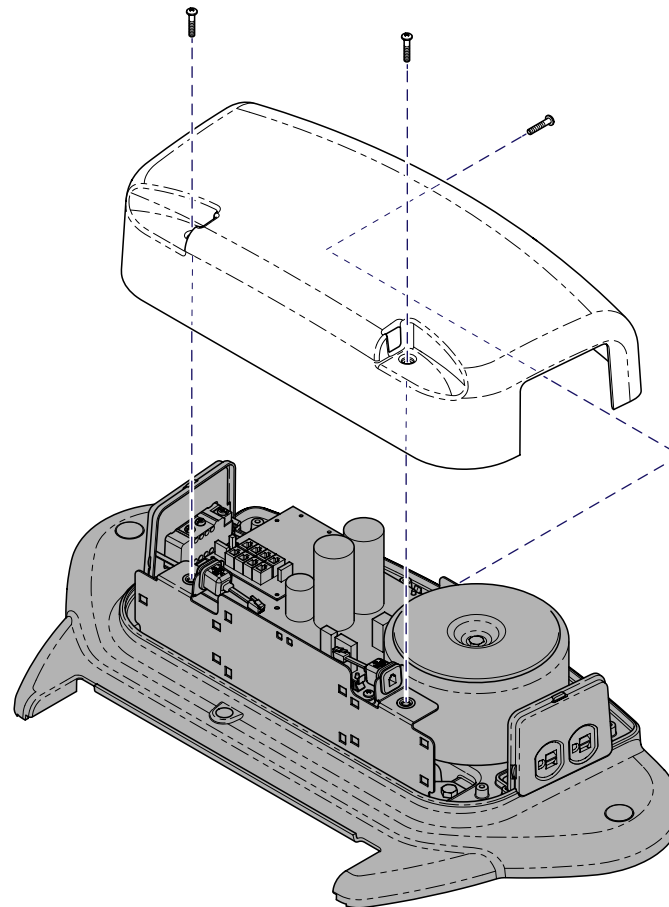

MA91811

To install base cover...

- A) Position cover on base.
- B) Secure with three screws.