

Cover Kit [002-1908-00]

Note

Access then refer to ATS-011030044 specification sheet when using the extraction tool (included).



Warning

Always disconnect power before removing covers.
Failure to do so may result in personal injury.

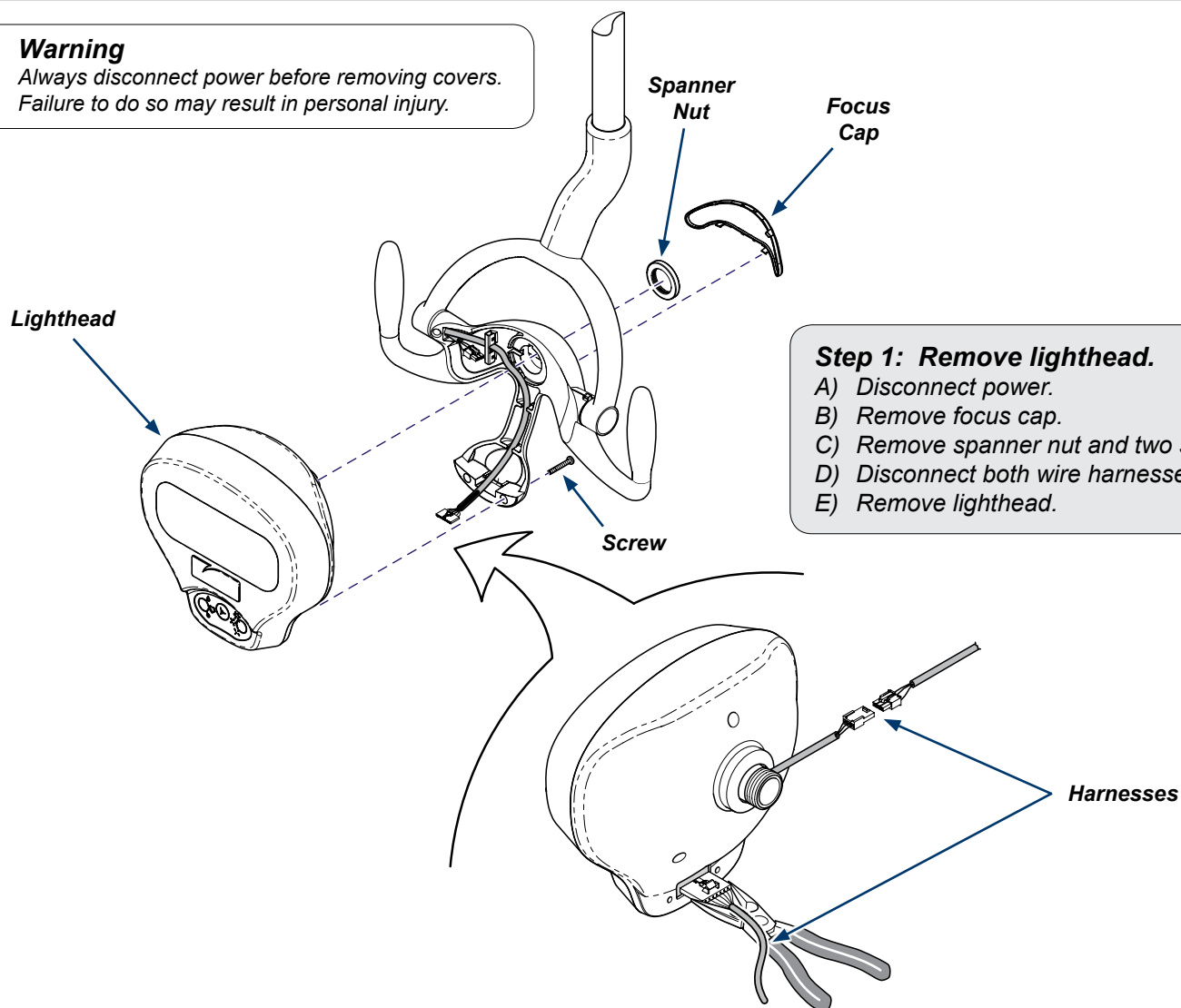

Step 1: Remove lighthead.

- Disconnect power.
- Remove focus cap.
- Remove spanner nut and two screws.
- Disconnect both wire harnesses.
- Remove lighthead.

Applies to Models:

153901 (-001 to -008)
153902-001
153903-001
153904-002
153905-002
153906 (-010 to -018)
153907 (-010 to -018)
153908
153909
153910
153912
153914-002
153915 (-002, -004)
153938 (-001 to -004)
002-1530-00
002-1532-00
002-1534-00
002-1536-00

Special Tools:

Spanner Wrench
Thin Needle Nose Pliers
Extraction Tool (included)



Equipment Alert

Handle light assembly with care to avoid damage. Only remove screws in locations shown. Refer to ATS-011030044 specification sheet when using the extraction tool (included).

Step 2: Remove existing harness.

- A) Remove three screws from back cover to access light assembly as shown.
- B) Carefully place back cover aside with interior harness still connected.
- C) Using the extractor tool, remove three wires from harness connector as shown (channel up / connector tab on top).
- D) Move harness through hole and remove from light.

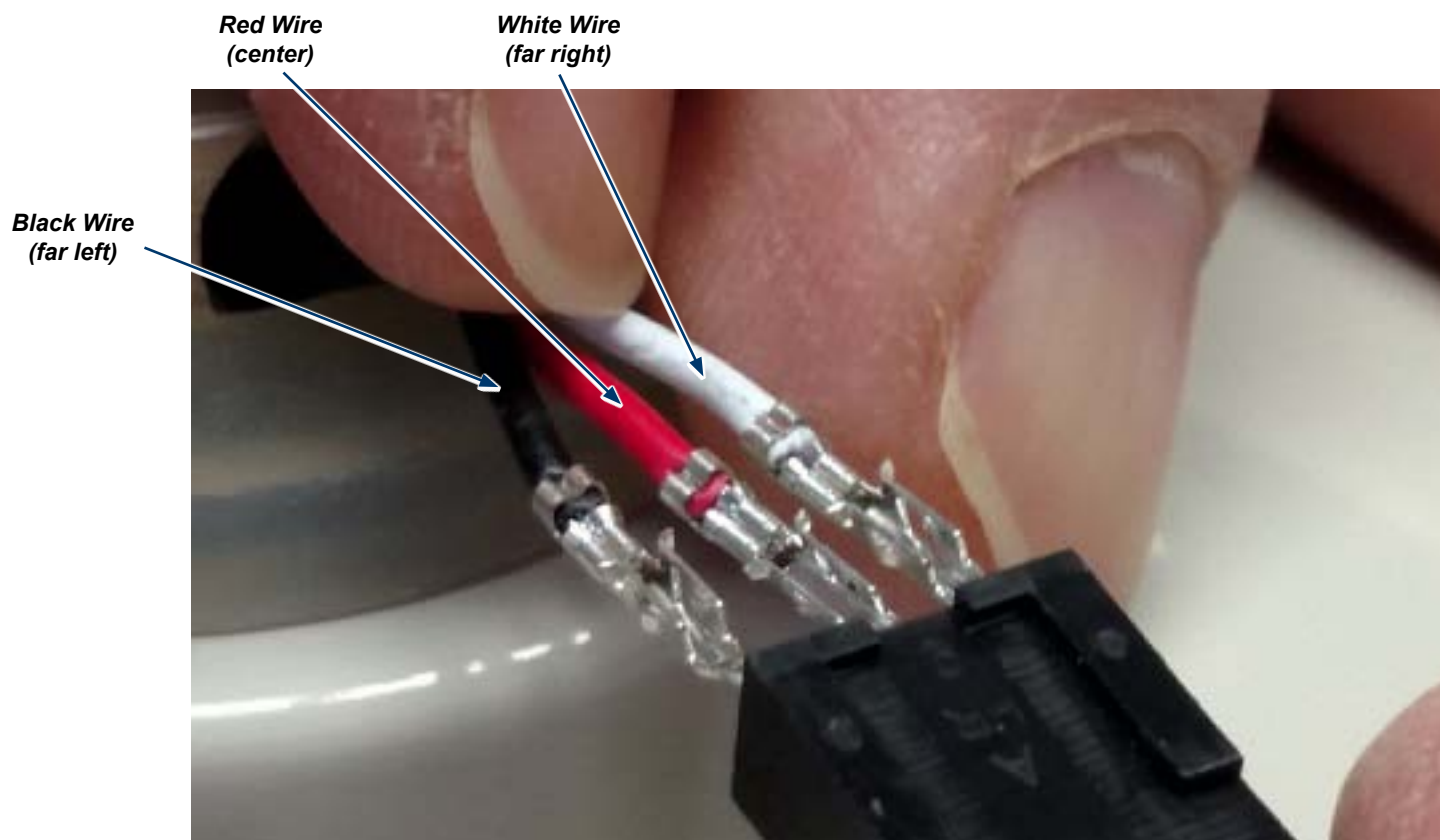
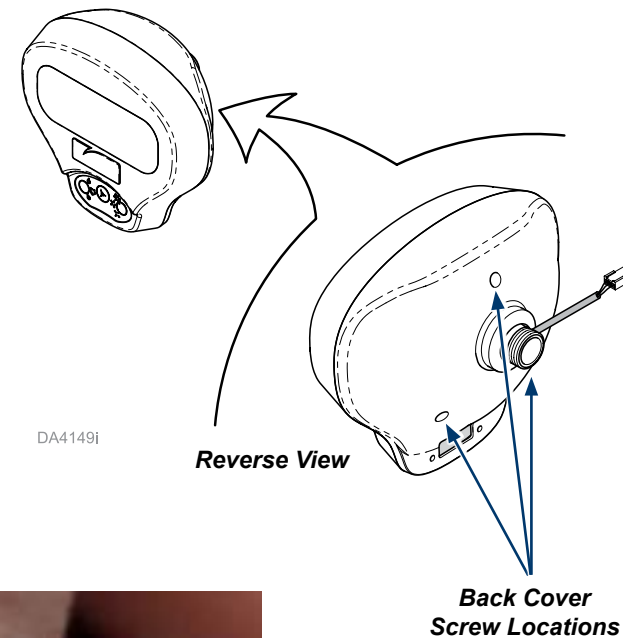

DA4451i



Equipment Alert

Handle light assembly with care to avoid damage. Only remove screws in locations shown.

Step 3: Remove existing lighthouse assembly.

- A) Remove housing and grommet from back cover as shown.
- B) Remove eight screws from light assembly bottom.
- C) Remove light assembly while still connected to harness.

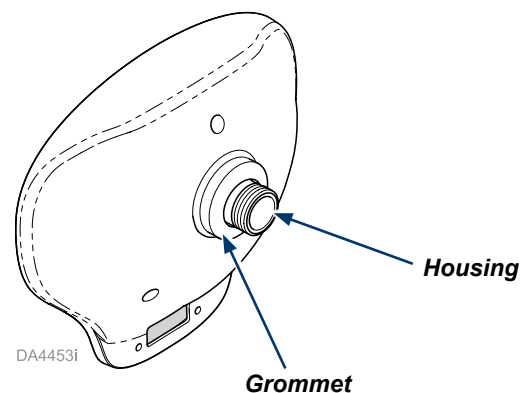

**Screw Locations
(One of Two
Long Sides Shown)**

**Screw Locations
(One of Two
Short Sides Shown)**

**Harness
(Keep Connected)**



**Equipment Alert**

Use clean hands or latex / lint free gloves when handling the light lens and diffuser to avoid damage.
Place diffuser in the correct orientation as shown with the shiny side facing down against the front cover window.

Step 4: Prepare new covers.

- A) Install previously removed grommet and housing to new back cover.
- B) Remove any screws and protective pieces from covers.
- C) Install new light lens then diffuser on top of front cover window as shown.

Light Lens / Diffuser





Equipment Alert

Handle light assembly with care to avoid damage. Install screws in locations previously shown.

Step 5: Install existing light assembly (with harness connected) to new covers.

A) Reverse Step 3 then Step 2.

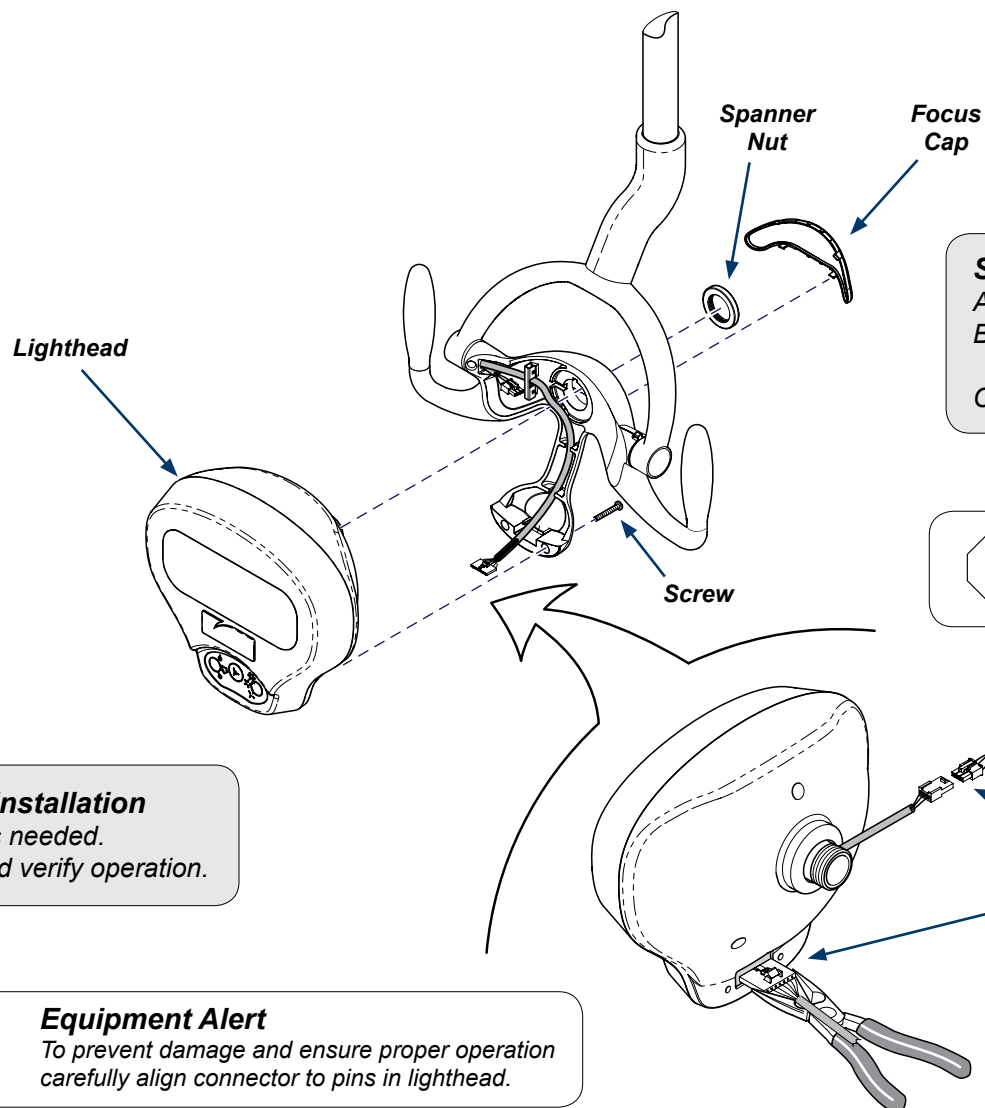

Step 6: Install lighthead.

- A) Connect wire harnesses as shown.
- B) Secure lighthead to light mount with spanner nut and two screws.
- C) Install focus cap.



Equipment Alert

To ensure proper operation, connect wiring harnesses as shown.

Step 7: Complete installation

- A) Clean lighthead as needed.
- B) Connect power and verify operation.



Equipment Alert

To prevent damage and ensure proper operation carefully align connector to pins in lighthead.

DA4145j