

# Pump Replacement Kit Installation [002-2093-00]



## WARNING

To prevent risk of shock always disconnect power before removing covers or performing any service procedure.

### Step 1: Remove shipping bolts and plugs from new pump.

- A) Remove lock nuts, washers and bolts from the new pump. Shipping hardware can be thrown away, they will not be reused.
- B) Remove shipping plugs from the intake and exhaust ports of the new pump.
- C) Remove lifting eye bolt from the new pump.

### Applies to Models:

Single Vac Units  
G3 (all), G5 (all), G7 (all)

Twin Vac Units  
G6 (all), G10 (all), G14 (all)

### Special Tools:

Ratchet  
6 inch & 9 inch Extension  
1/2, 9/16, & 3/4 inch Socket

Language of origin: English

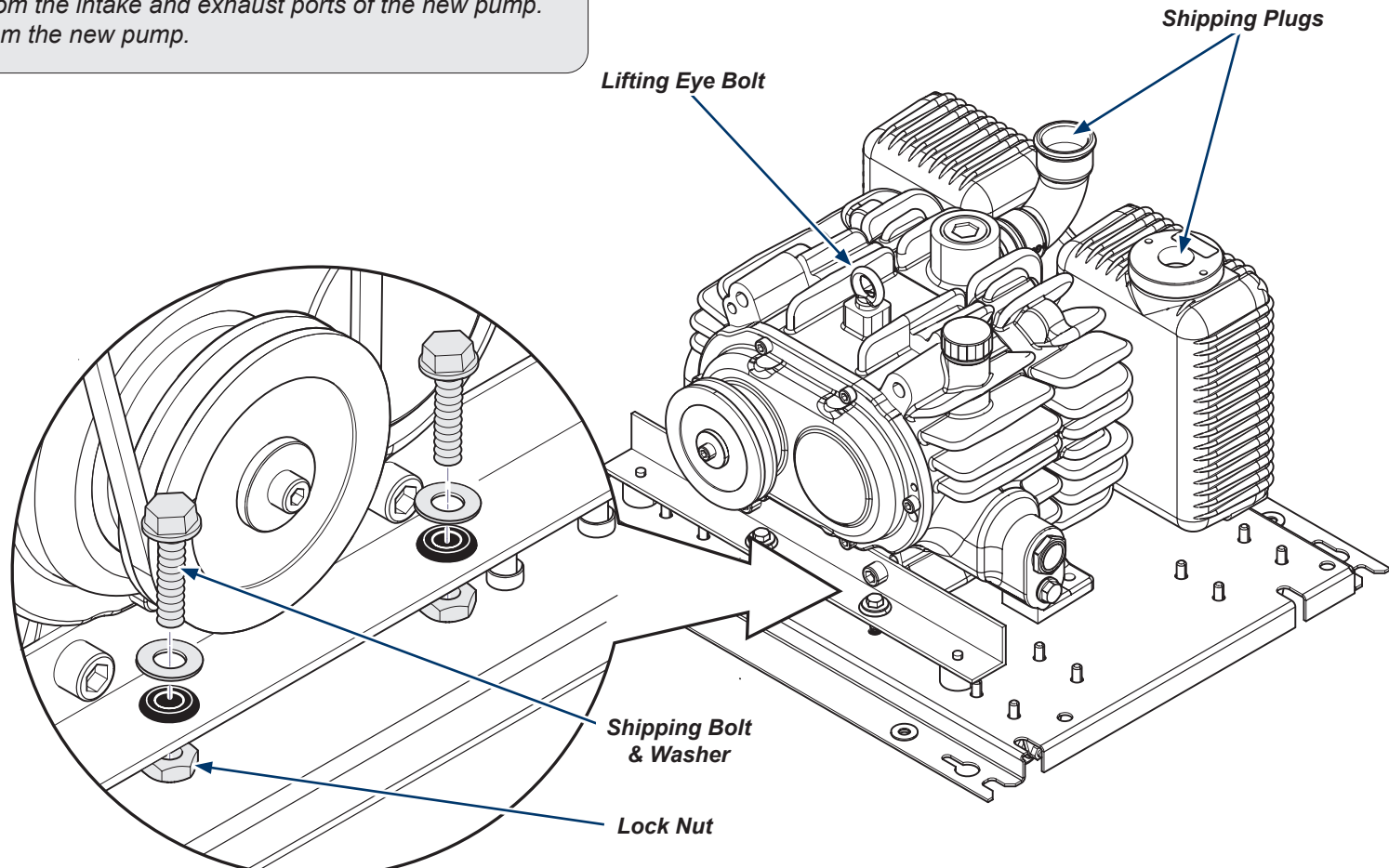

# Disassembly



## Caution

Vac base unit weighs 375 lbs (170 kgs). Use care when moving to prevent personal injury. Raise leveling feet to roll base unit or use lift handles (77001455).

## Step 2: Remove front and back covers.

- Disconnect main power.
- Position power vac so you have room to work.
- Remove front and back covers by turning the bottom screws a 1/4 turn, pulling the bottom of cover away from the base, (remove grounding screw from top of back cover) and lift cover up and off the base.

Note: The base of the power vac is equipped with swivel casters raise the leveling feet up in order to utilize casters.

## Note

Connected models (-050's) will have clear tubing to disconnect at Quick Connections on the tank lid. Keep tubing with the base on barbed connections.

## Step 3: Remove collection tank.

- Disconnect operator, intake, & drain hoses from tank if needed so that the tank and top plate will sit on the floor.
- Disconnect the float and pressure sensor harnesses from the back of the base.
- Disconnect clear tubing at Quick Connections on the tank lid.
- Disconnect the red, white & blue low voltage control wires at the back of the base.
- Remove four bolts attaching top plate, remove top plate and tank and position on the floor.

Note: If disconnecting hoses make sure the tank and hoses are empty.

1/4 Turn  
Screws

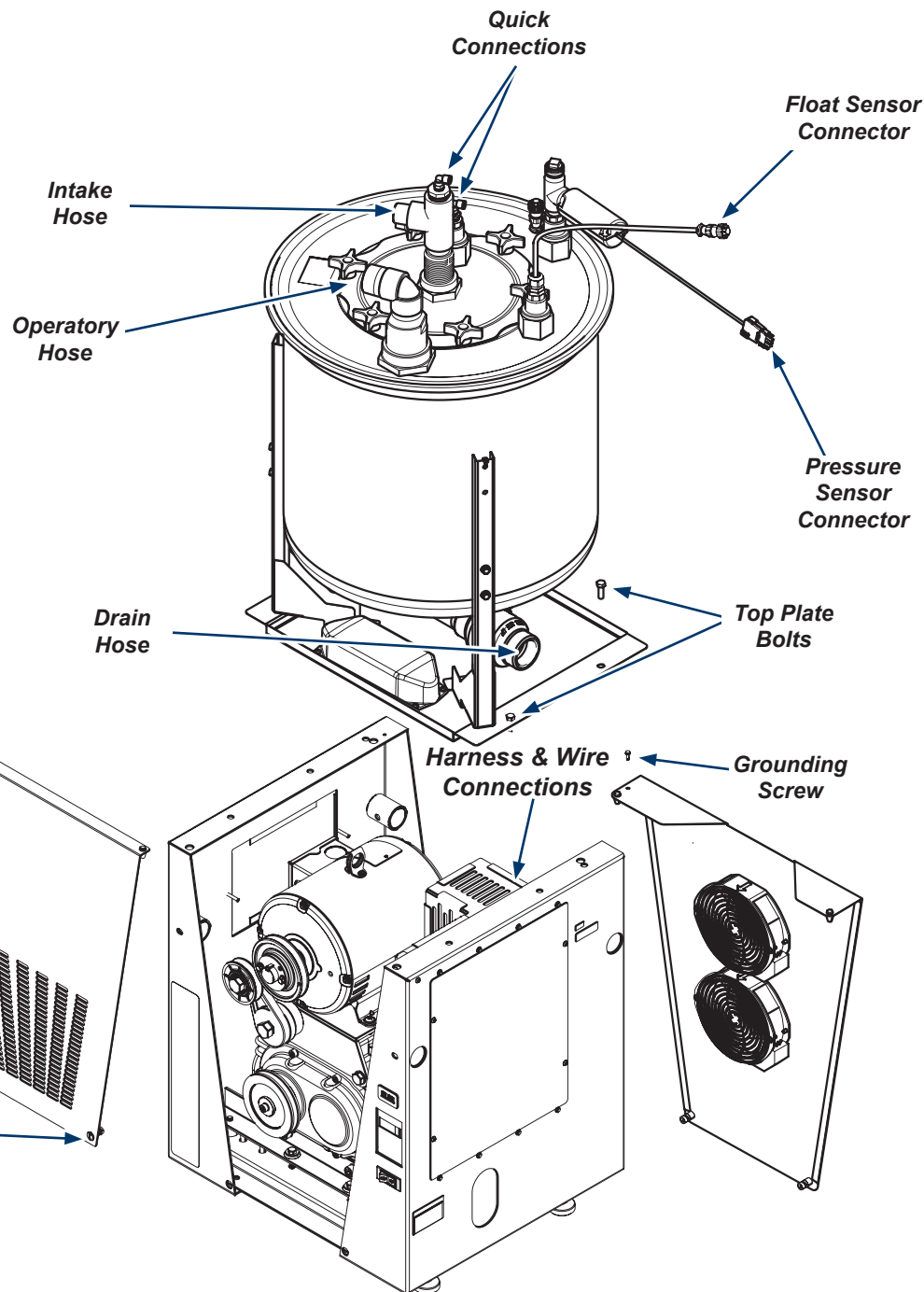

# Disassembly

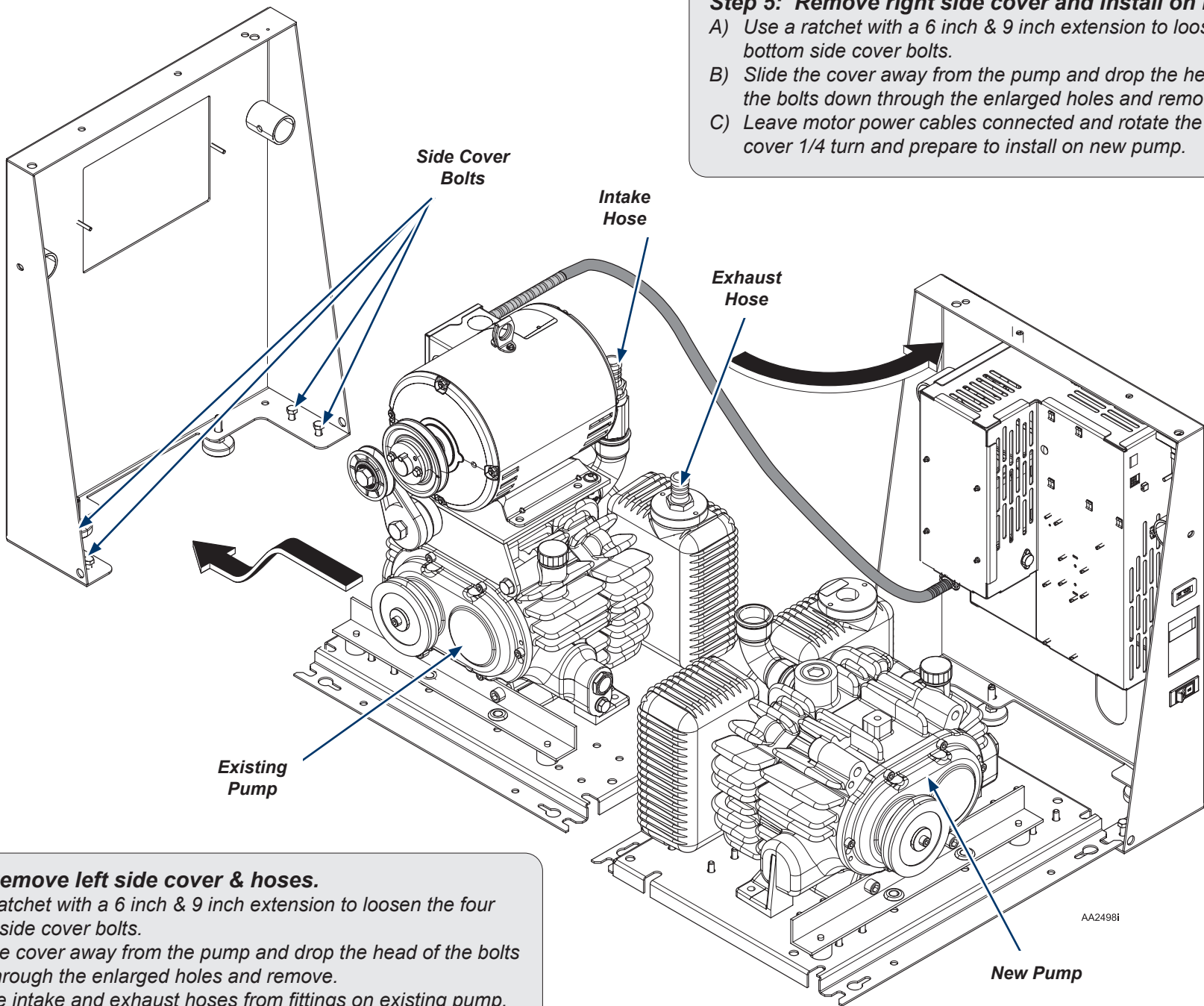

## Step 5: Remove right side cover and install on new base.

- A) Use a ratchet with a 6 inch & 9 inch extension to loosen the four bottom side cover bolts.
- B) Slide the cover away from the pump and drop the head of the bolts down through the enlarged holes and remove
- C) Leave motor power cables connected and rotate the right cover 1/4 turn and prepare to install on new pump.

## Step 4: Remove left side cover & hoses.

- A) Use a ratchet with a 6 inch & 9 inch extension to loosen the four bottom side cover bolts.
- B) Slide the cover away from the pump and drop the head of the bolts down through the enlarged holes and remove.
- C) Remove intake and exhaust hoses from fittings on existing pump.

# Re-assembly

## Step 6: Remove & replace auto tensioner and motor mount.

- A) Position right side cover onto new pump base and tighten four bolts
- B) Lift up on auto tensioner and remove drive belt.
- C) Remove two bolts, lock washers, & nuts that mount the auto tensioner/motor to the pump.
- D) Install auto tensioner/motor onto new pump and tighten bolts.
- E) Re-install drive belt.

## Step 7: Install fittings, harnesses, covers, & hoses to new pump.

- A) Install new intake & exhaust fittings.
- B) Remove VRV valve off old pump and install on new intake fitting.
- C) Re-connect intake & exhaust hoses to new pump.
- D) Install left cover and top plate with tank.
- E) Re-connect tubing, float harness, pressure sensor harness and the red, white & blue low voltage control wires at the back of the base.
- F) Re-connect operator, intake, & drain hoses to tank (if needed).
- G) Install front & back covers and level unit.
- H) Apply power and test.

