

Replacement Compressor Head Midmark Models: P52 and P72 [77001544]

Applies to Models:

P52 (all)
P72 (all)

Special Tools:

none



WARNING

Always disconnect power before removing covers or performing any service procedures.

Removal

Step 1: Disconnect electrical power to the compressor.

Installation

Step 6: Connect electrical power to compressor.

Installation

Step 5: Install motor junction box cover.

Removal

Step 2: Remove motor junction box cover.

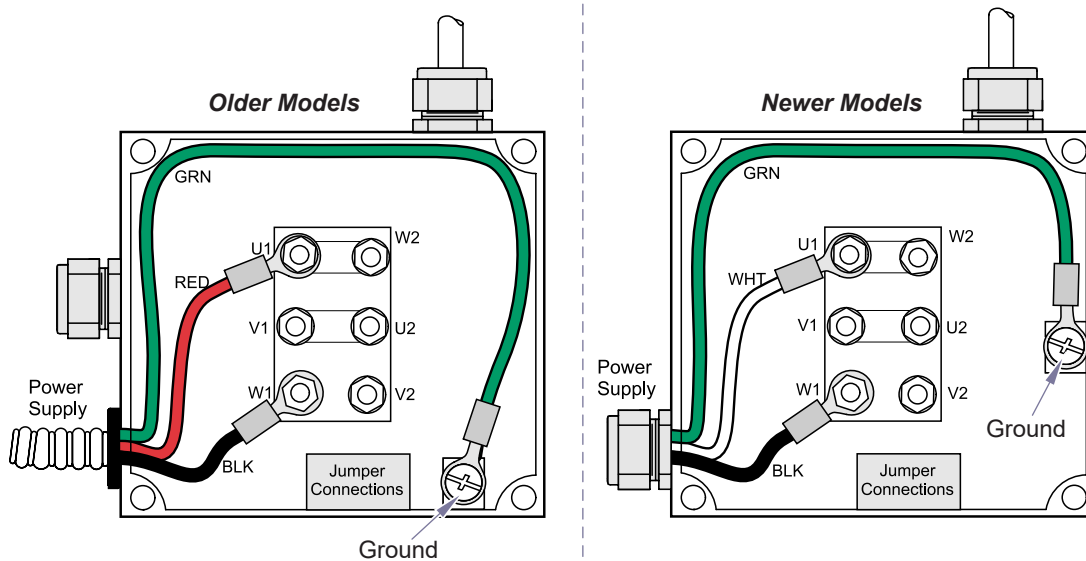

Removal

Step 3: Disconnect power supply wires in junction box.
Remove power supply cord/conduit from junction box.

Note: Go to page 2 for Step 4, Removal.

Installation

Step 4: Remove motor junction box cover.
Connect power supply wires.
Secure power supply cord/conduit to junction box.

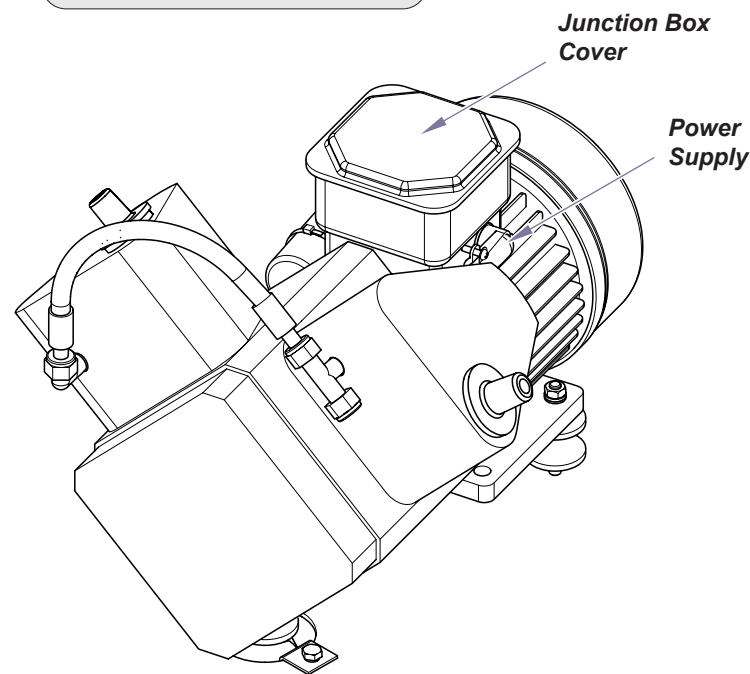

Removal

Step 4: Disconnect air and exhaust lines from old motor.

Installation

Step 3: Connect air and exhaust lines to new motor. Verify that filter elements are inserted fully into boots when reinstalling boots into ports.

Note: Go to page 1 for Step 4, Installation.

Installation

Step 1: Place head on mounts and position bracket in saddle.

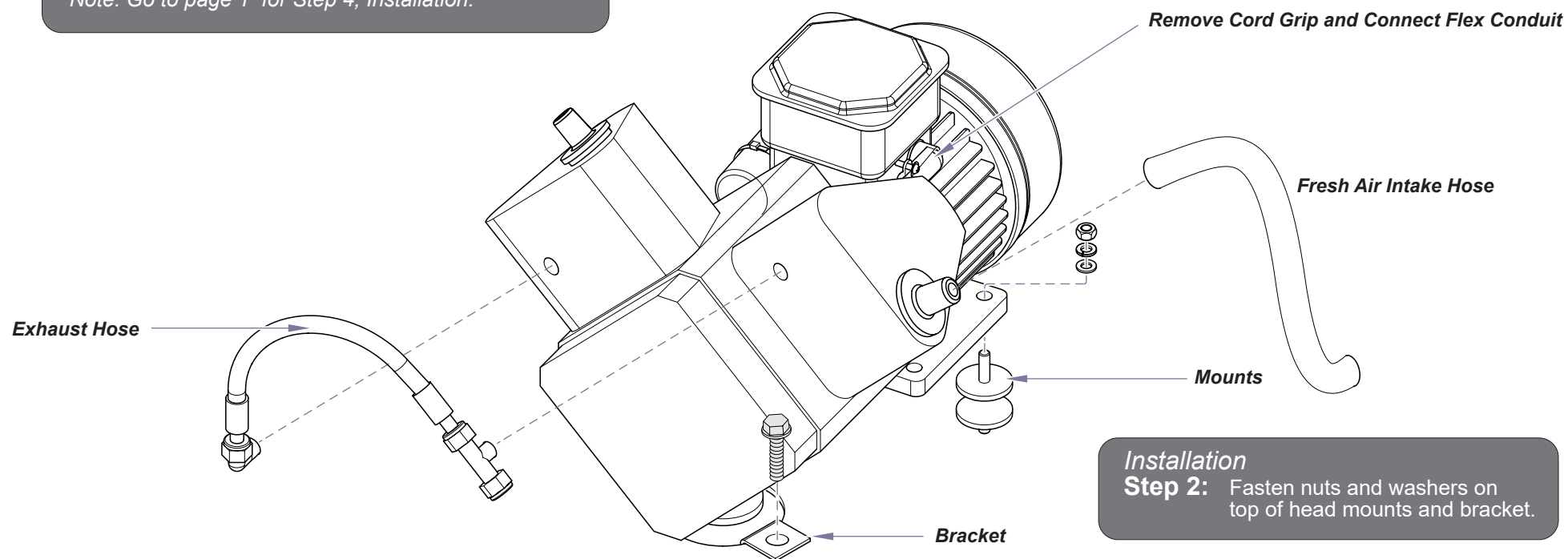

Installation

Step 2: Fasten nuts and washers on top of head mounts and bracket.

Removal

Step 5: Remove nut and washer from top of head mounts and bracket.

Removal

Step 6: Remove head from saddle.