

Attention:
Never lubricate this oil-less compressor.
The motor / crankshaft bearings and Teflon
compressor rings are permanently lubricated.

P21 / P22 Model Shown

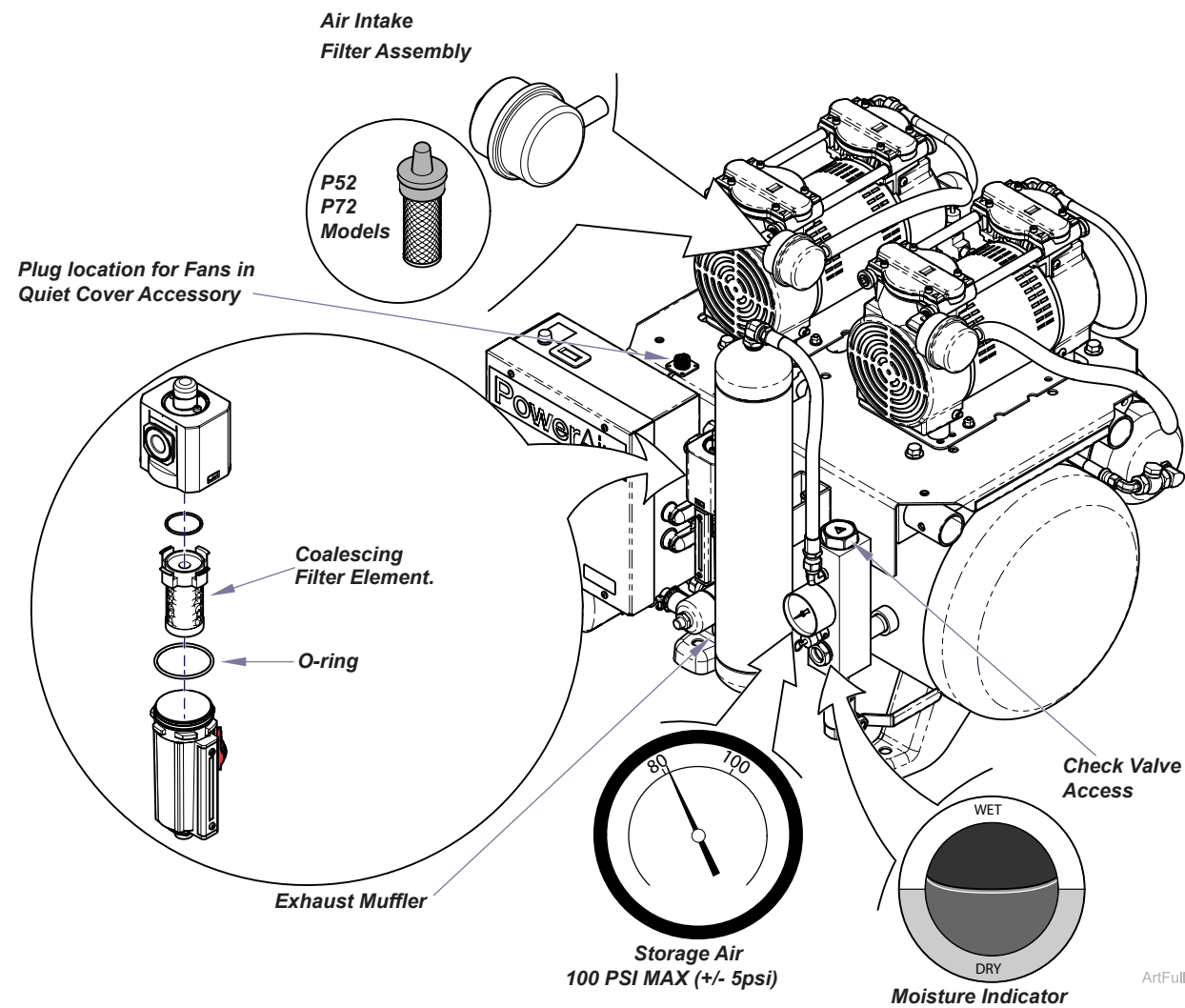

Duty cycle: When properly sized, the compressor should run a maximum of 35% of the time.

Changing Fuse

Only replace fuse with 1/3 amp,
250 volt, Slo Blo, fuse.

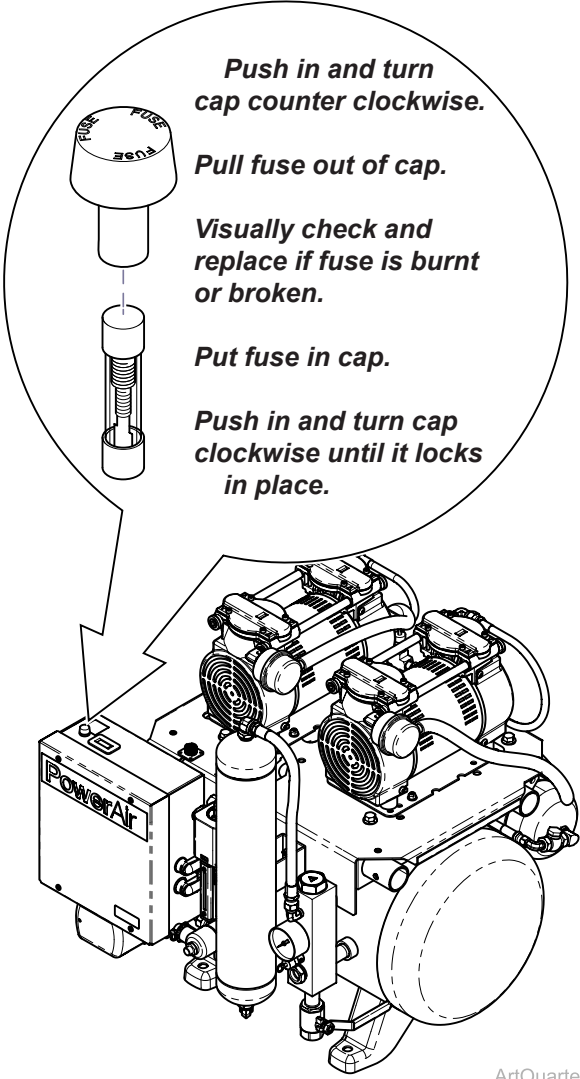

Weekly

- A. Check Moisture Indicator.**
If indicator is **BLUE**, no action is required.
If indicator is **PINK**, marginal life or compressor is overcycled.
If indicator is **WHITE**, dryer tank needs replacing.

Monthly

- A. Check Pressurization Time.**
Watch the Storage Air gauge as the compressor runs. Record the time it takes to go from 80 PSI to 100 PSI Max (+/- 5psi). It should take approximately 15 to 45 seconds.
[Contact your dealer if significantly out of range]
- B. Clean / Dust Compressor.**
Wipe with a clean cloth to remove dust & debris.

Annually

- A. Replace Air Intake Filters.**
The number of air intake filters varies by model.
You must replace all of these filters annually.
- B. Replace Coalescing Filter Element and O-ring**
All models have only one coalescing filter element.

Bi-Annually

- A. Replace Exhaust Muffler.**

Maintenance Kits / Parts

P21 - P22 - P32 (Order Kit #: 002-10807-00)

- Kit Includes:
- Air Intake Filters (3)
 - Coalescing Filter Element. (1)
 - O-Ring (2)

P52 (Order Kit #: 002-10805-00)

- Kit Includes:
- Air Intake Filters (4)
 - Coalescing Filter Element. (1)
 - O-Ring (2)

P72 (Order #: 002-10806-00)

- Kit Includes:
- Air Intake Filters (6)
 - Coalescing Filter Element. (1)
 - O-Ring (2)

Specifications

Classifications: Class 1, No Applied Part



Model	# Users	CFM @ 80 PSI	Total HP	Tank Capacity	Voltage	Total Amps	Breaker Size	Sound Level (dBA)	Sound Level (dBA) With Quiet Cover	Dimensions H x W x D (IN.)	Dimensions With Sound Cover H x W x D (IN.)	Product Weight (LBS.)	Fresh Air Intake Pipe Size
P21	1 - 3	5.2	1.5	10	115	16.0	20	65	60	27 x 26 x 24	32 x 26 x 25	225	2"
P22	1 - 3	5.2	1.5	10	208-230	7.0	20	65	60	27 x 26 x 24	32 x 26 x 25	225	2"
P32	3 - 5	7.8	2.25	20	208-230	11.0	20	67	62	29 x 33 x 26	33 x 33 x 28	295	2"
P52	5 - 7	10.6	3.2	20	208-230	20.0	30	70	65	31 x 33 x 26	33 x 33 x 28	345	2"
P72	7 - 10	15.9	4.8	32	208-230	29.0	40	73	68	33 x 40 x 27	39 x 40 x 30	425	2"

Maintenance Guide
PowerAir™ Compressors

Intended Use
To provide air pressure during general examinations and procedures conducted by qualified dental professionals.

To ensure years of reliable service, follow the maintenance schedule outlined in this guide. If service is required, contact your authorized Midmark dealer.

Dealer (name / phone):

Model Number:

Serial Number:

Date of Purchase:

Warranty Registration



SCAN ME

Warranty Information



SCAN ME

Annual Maintenance Log

Date:	Services Performed:	Technician:
<div></div>	<div></div>	<div></div>
<div></div>	<div></div>	<div></div>
<div></div>	<div></div>	<div></div>
<div></div>	<div></div>	<div></div>
<div></div>	<div></div>	<div></div>
<div></div>	<div></div>	<div></div>
<div></div>	<div></div>	<div></div>
<div></div>	<div></div>	<div></div>
<div></div>	<div></div>	<div></div>