

Daily

A. Replace Collection Canister

Midmark collection canisters are designed for single patient use only. Refer to collection canister manufacturer directions for replacement.

Bi-Annually

A. Clean Air Vents on Motors

Disconnect power. Wipe with a clean cloth to remove dust and debris.

Annually

A. Replace Vacuum Filter

Procedure is located in this guide.

B. Drain Moisture from Tank

Open service valve to drain any accumulated moisture in tank.

As Necessary

A. Vacuum Pump Flushing

Vacuum pump(s) can be flushed to remove deposits which build up on the pump vanes over time. Removal of these deposits will help to maintain proper vane performance. Contact Midmark Service Technician.

B. Adjust Vacuum Setpoints

Adjust vacuum setpoints at initial setup or when needed. Procedure is located in this guide.

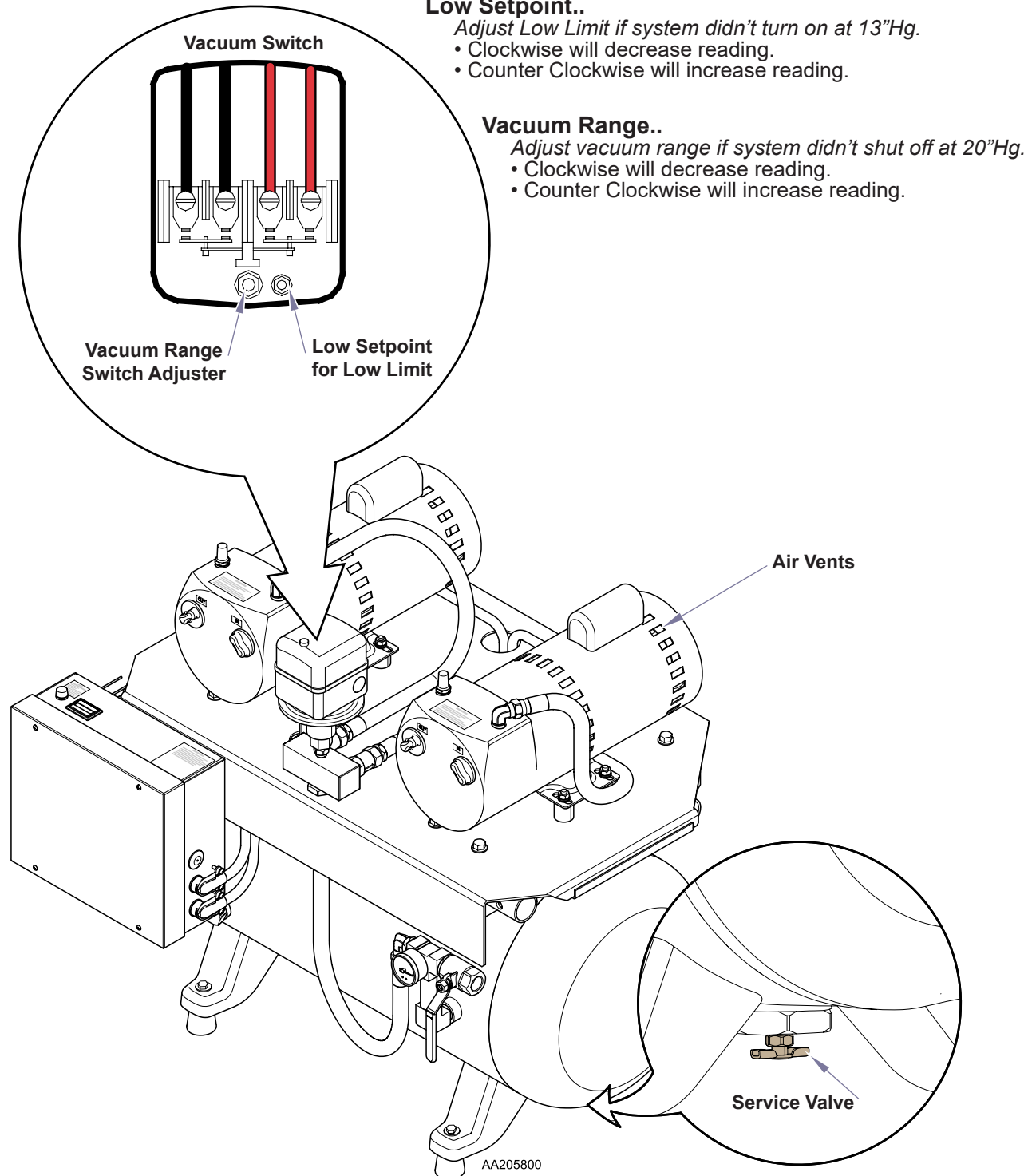

Low Setpoint..

Adjust Low Limit if system didn't turn on at 13"Hg.

- Clockwise will decrease reading.
- Counter Clockwise will increase reading.

Vacuum Range..

Adjust vacuum range if system didn't shut off at 20"Hg.

- Clockwise will decrease reading.
- Counter Clockwise will increase reading.

Maintenance Kits

Vacuum Filter

Order #: 77000796

Includes:

- 1 Filter (Order 2 per Head)

Flushing Solvent

Order #: 77000699

Accessories

Exhaust

(PM-1 and PM-3) Order #: 77000894

(PM-4) Order #: 77000895

Includes:

Exhaust kit to vent PowerMax to the outside.

Surgical Operatory Recovery Room Package

Order #: 77008037

Includes:

- Pkg of 5 Disposable Canisters (1200 cc)
- DISS Free Flow Regulator
- Outlet Station: Vacuum DISS
- Conductive Tubing - 6'
- Vacuum Slide and Ring
- Replacement Elbow

Disposable Canisters

(1200 cc)

Order #: 002-1882-00

Includes:

- Pkg of 5 Canisters

Midmark Corporation
60 Vista Drive
Versailles, OH 45380 USA
1.800.643.6275
1.937.526.3662
midmark.com

Filter Replacement

- Shut off power at supply box.
- Vent tank by closing ball valve and opening service valve.
- Allow pump(s) to cool.
- Unscrew end cap from pump(s).
- Remove filter(s) and o-ring(s).
- Replace with new filter(s) and o-ring(s).

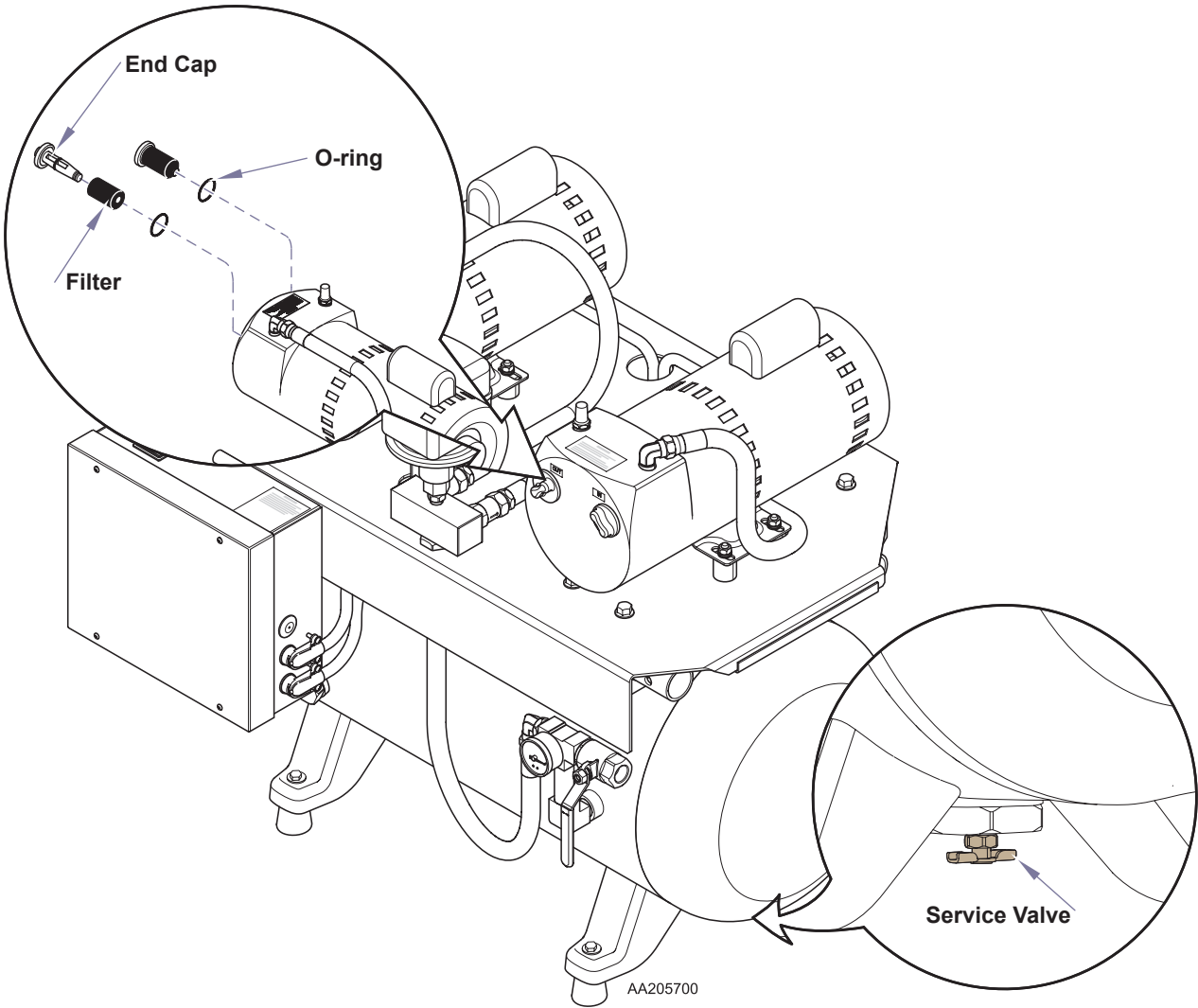

PowerMax High Performance Vacuum Maintenance Guide

To ensure years of reliable service, follow the maintenance schedule outlined in this guide. If service is required, contact your authorized Midmark dealer.

Dealer (name / phone):

Model Number: _____
Serial Number: _____
Date of Purchase: _____

Warranty Information



SCAN ME

Warranty Registration



SCAN ME

Annual Maintenance Log

Date:	Services Performed:	Technician:
_____	_____	_____
_____	_____	_____
_____	_____	_____
_____	_____	_____
_____	_____	_____
_____	_____	_____
_____	_____	_____
_____	_____	_____
_____	_____	_____
_____	_____	_____