

# INSTALLATION INSTRUCTIONS for Unit Post Mounted Water System P/N 152360-01 & -02

(This water system device is designed to mount to the unit post when an assistant's console is not present.)

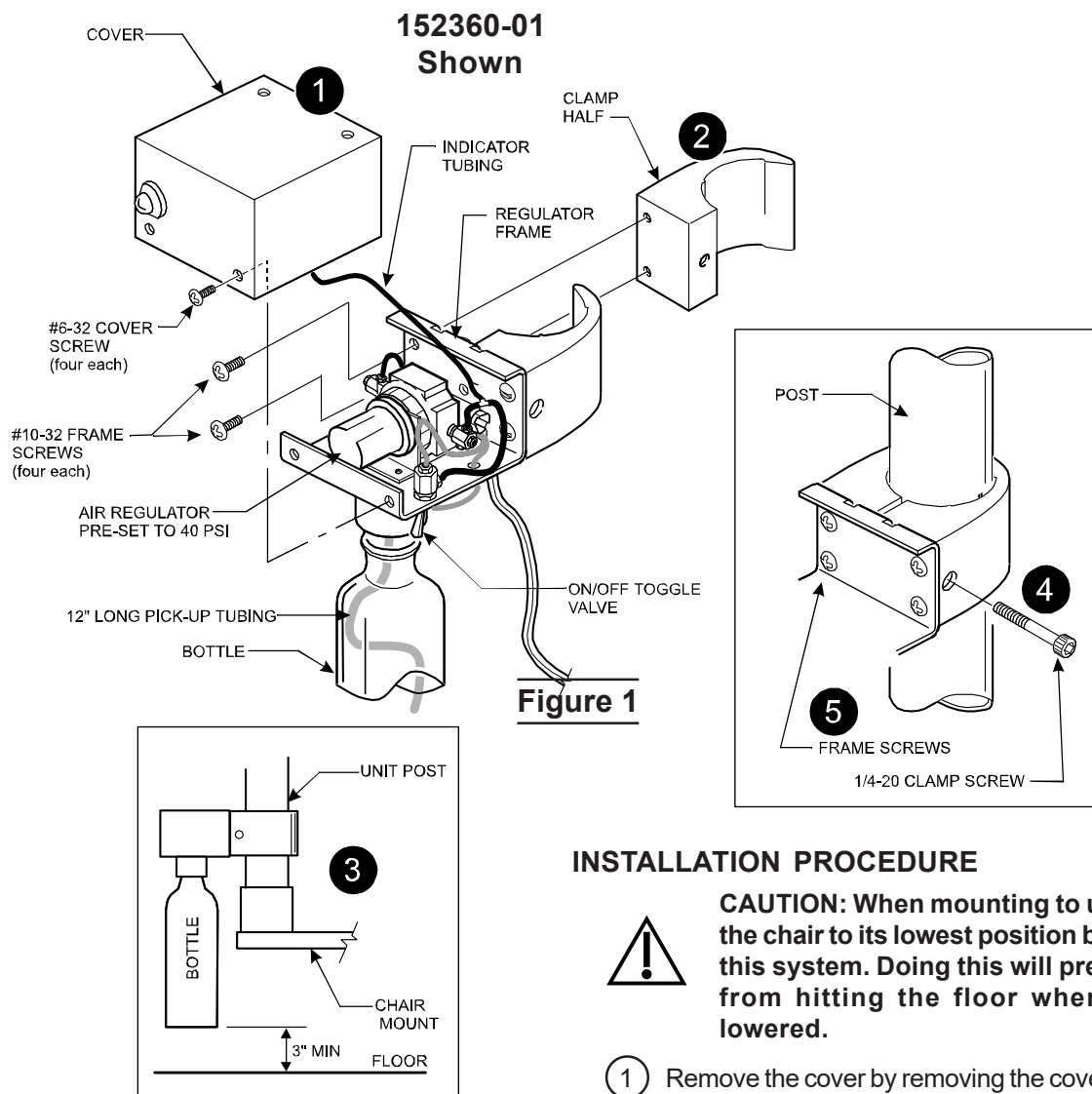

## INSTALLATION PROCEDURE



**CAUTION:** When mounting to unit post, lower the chair to its lowest position before installing this system. Doing this will prevent the bottle from hitting the floor when the chair is lowered.

- ① Remove the cover by removing the cover screws. Do not disconnect the indicator tubing (See Figure 1).
- ② Remove one half of the clamp (if required) by removing two of the frame screws.
- ③ With the chair lowered all the way, position the clamp and water system on the unit so that the bottle is at least 3 inches above the floor.
- ④ Insert the clamp screw and tighten.
- ⑤ Tighten the four frame screws while checking the bottle to make sure it is plumb. Replace the cover.

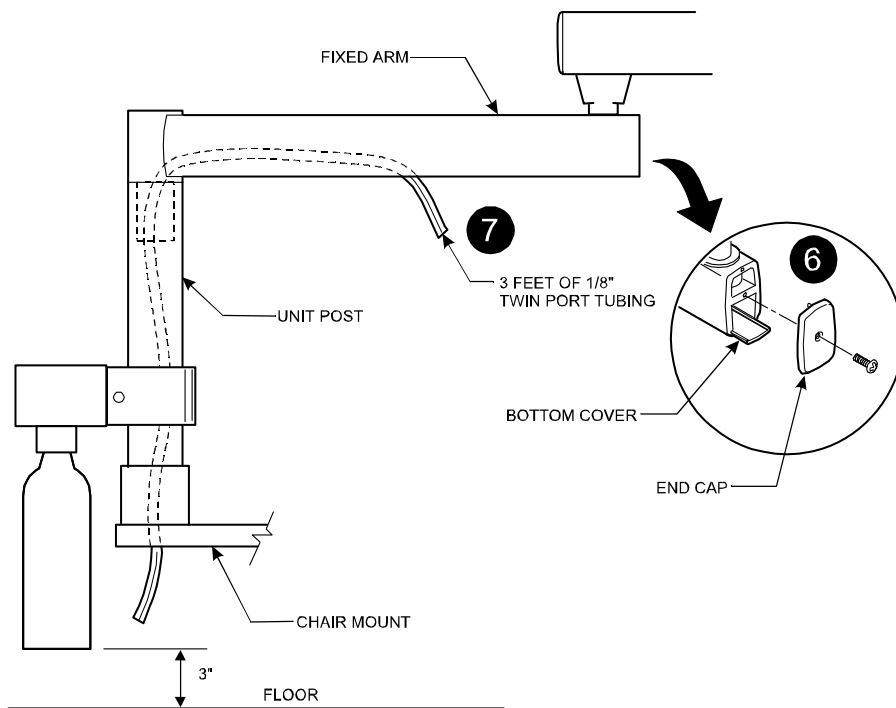

**Figure 2**

- ⑥ Remove the end cap from the fixed arm and slide out the bottom cover to gain access to the tubing inside (See Figure2).
- ⑦ Route 3 feet of the 1/8" twin port tubing supplied into the fixed arm and down through the unit post as shown.
- ⑧ Cut the twin port tubing, coming from the water system, down to approximately 12 inches in length (see Figure 3).
- ⑨ Connect this tubing to the 3 feet of twin port tubing coming from the unit post using the barb fittings and retainers provided (**match ribbed tube to ribbed tube**). Push the connections up into the unit post and out of sight.

CONTINUED NEXT PAGE

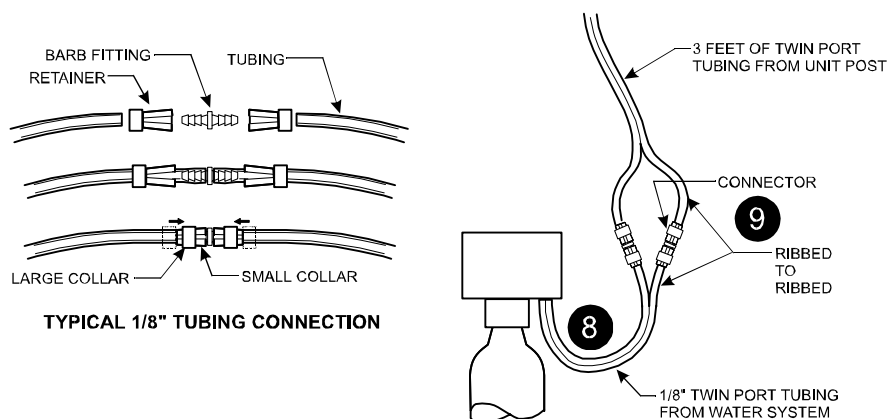

**Figure 3**

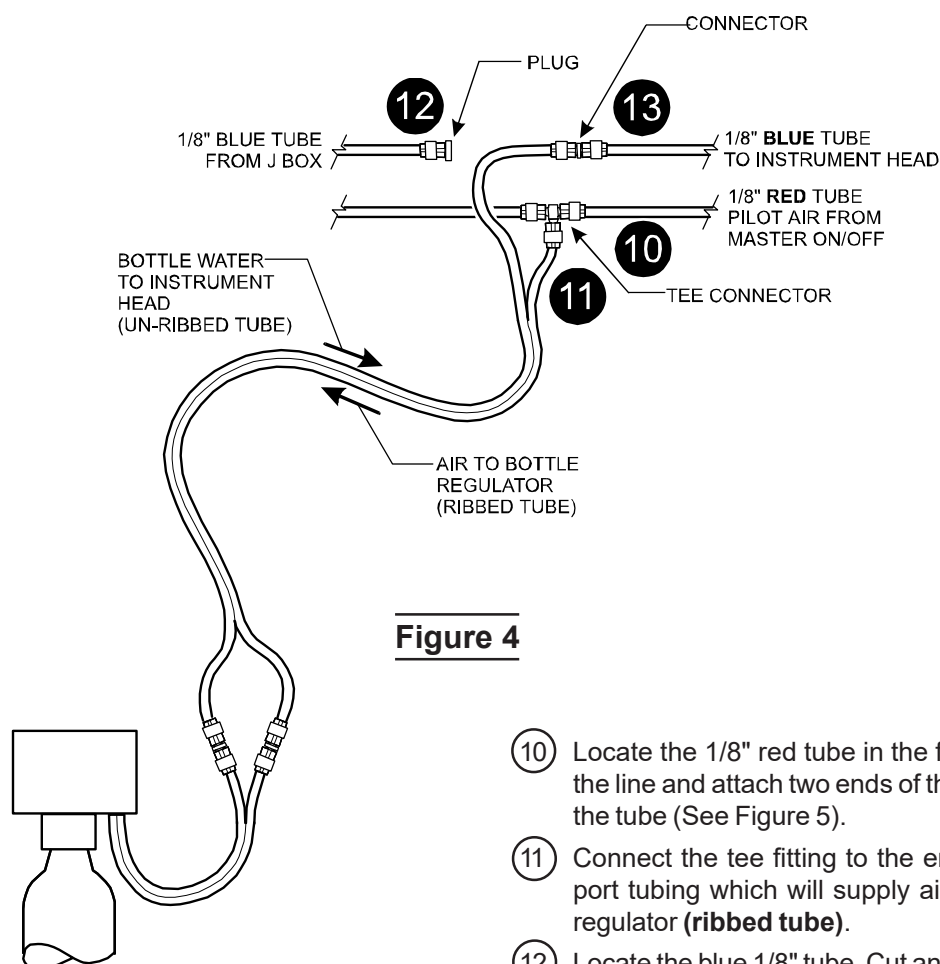

**Figure 4**

- ⑩ Locate the 1/8" red tube in the fixed arm. Cut the line and attach two ends of the tee fitting to the tube (See Figure 5).
- ⑪ Connect the tee fitting to the end of the twin port tubing which will supply air to the bottle regulator (**ribbed tube**).
- ⑫ Locate the blue 1/8" tube. Cut and plug the end coming from the J box.
- ⑬ Attach the other end of the blue tube to the remaining twin port tubing end (**un-ribbed tube**). This step connects the water line from the bottle to the instrument head.
- ⑭ Arrange the tubing and connections neatly in the fixed arm to avoid kinking and replace the bottom cover and end cap.

## OPERATION & USE

This device delivers bottled liquids to the handpieces and syringe at 30 psig (static) by controlled air pressure. The air pressure is regulated to 40 psig by the built in regulator. **DO NOT RE-ADJUST THE REGULATOR TO A HIGHER PRESSURE AS IT MAY CAUSE THE BOTTLE TO RUPTURE.**

The on/off toggle turns the air to the bottle on or off, thereby controlling the delivery of the solution. On/off is visually indicated by the indicator on the cover of the device. **ALWAYS TURN THE AIR OFF WHEN REMOVING THE BOTTLE FOR REFILLING.**

## REPLACEMENT BOTTLES

REORDER KNIGHT PART # 002-0777-00, 1 LITER (34 FL.OZ. OR 1 QUART)

REORDER KNIGHT PART # 153282 , 2 L ITER (68 FL.OZ. OR APPRX. 2 QUARTS)

# MOUNTING INSTRUCTIONS

## for Universal Mounted Water System P/N 152360-02

This Water System Device is designed to mount to cart frames or unit post (2" dia.) using clamps supplied. It can also be mounted to cabinets or walls using suitable screws provided by the installer.

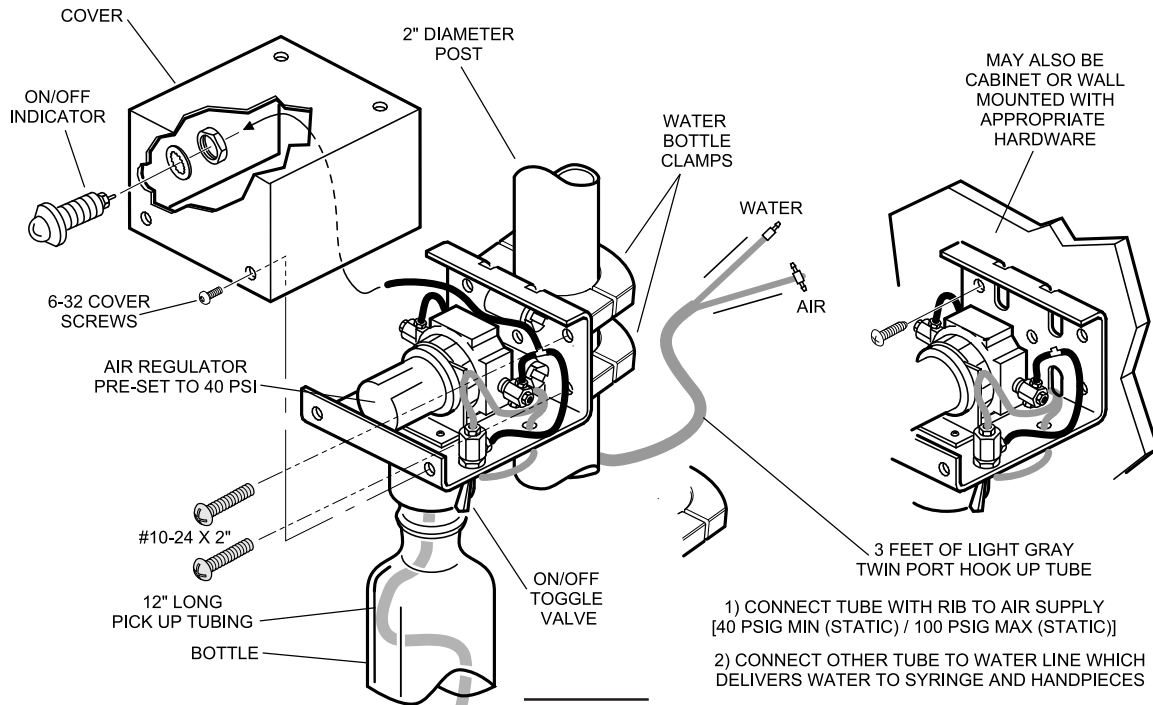

**Figure 5**

DA2011001

### CONNECTION

This device requires connection to air [40 psig min (static)/ 100 psig max (static)].

1) Connect air to the twin port hook up tube with the rib. Water to be supplied will be delivered from the other tube (un-ribbed) (See Figure 5).

2) Connect the un-ribbed tube to the tube which delivers water to the desired instruments.

### DUAL BOTTLE INSTALLATION

Two or more bottles may be connected together to deliver different solutions (See Figure 6).

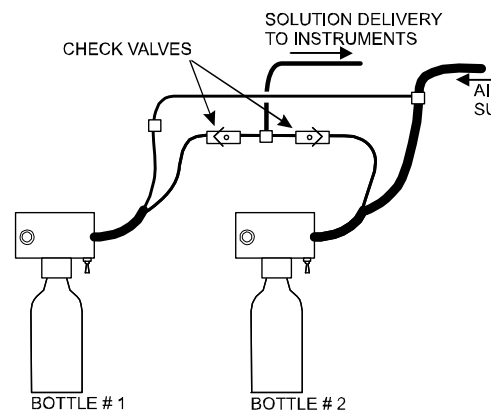

**Figure 6**

**Knight®**  
by Midmark

Midmark Corporation • 60 Vista Drive • P O Box 286  
Versailles • Ohio • 45380-0286 • www.midmark.com  
Phone: 937-526-3662 Fax: 937-526-5542