



Mineral Deposit Reducer Installation AVA82000

Components:

Filter Assy	1
Bracket Kit	1
Bowl Wrench	1
16' Tubing	1
Bushing (1/2" X 1/4")	1
Quick Connect Fittings	4

Intended Use:
To prevent scale and mineral deposits from adhering to the wet-ring vacuum components.

Requirements / Restrictions:
Install Mineral Deposit Reducer according to local codes.
Protect from freezing.
Do NOT Install: • On line pressures above 100 PSI.
• Near direct sunlight or heat producing equipment.

Step 1: Turn off vacuum system.
Turn off the incoming water source.
Disconnect the water inlet hose from vacuum.

Step 2: Install mounting bracket to wall.
Install Mineral Deposit Reducer to bracket.

Step 3: Install quick connect fittings to "In" and "Out" ports.
Note: Direction of water flow through Mineral Deposit Reducer must be maintained during installation.

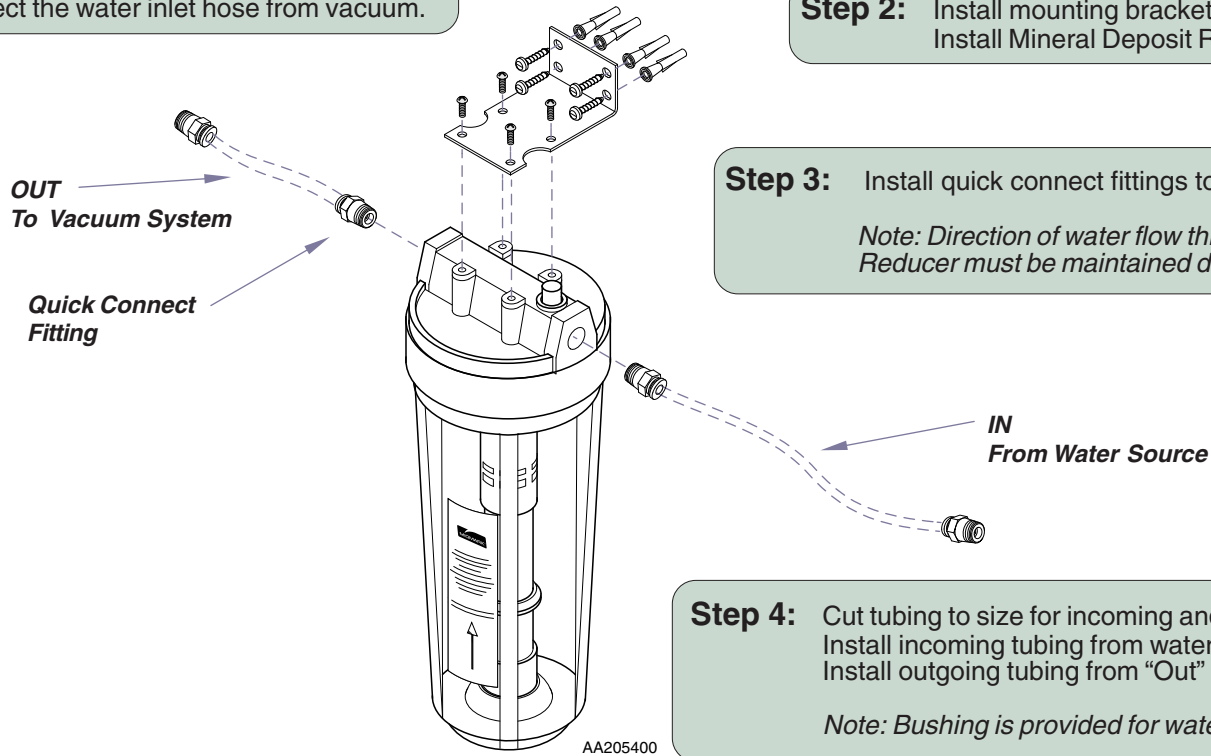

Step 4: Cut tubing to size for incoming and outgoing water connections.
Install incoming tubing from water source to "In" port.
Install outgoing tubing from "Out" port to vacuum inlet connection.
Note: Bushing is provided for water source connection if needed.

Step 5: Turn water source on.
Turn vacuum system on.
Check for leaks in system.

**LIMITED WARRANTY
SCOPE OF WARRANTY**

Midmark Corporation ("Midmark") warrants to the original purchaser its Air and Vacuum accessories (except for components not warranted under "Exclusions") manufactured by Midmark to be free from defects in material and workmanship under normal use and service. Midmark's obligation under this warranty is limited to the repair or replacement, at Midmark's option, of the parts or the accessories the defects of which are reported to Midmark within the applicable warranty period and which, upon examination by Midmark, prove to be defective.

APPLICABLE WARRANTY PERIOD

The applicable warranty period, measured from the date of installation for the original user, shall be:

- Midmark Air and Vacuum Accessories: 90 Days

EXCLUSIONS

This warranty does not cover and Midmark shall not be liable for the following: (1) repairs and replacements because of misuse, abuse, negligence, alteration, accident, freight damage, or tampering; (2) products which are not installed, used, and properly cleaned as required in the Midmark "Installation" manual and/or "Maintenance" guide for this applicable product; (3) products considered to be of a consumable nature; (4) accessories or parts not manufactured by Midmark; (5) charges by anyone for adjustments, repairs, replacement parts, installation, or other work performed upon or in connection with such products which is not expressly authorized in writing in advance by Midmark.

EXCLUSIVE REMEDY

Midmark's only obligation under this warranty is the repair or replacement of defective parts. Midmark shall not be liable for any direct, special, indirect, incidental, exemplary, or consequential damages or delay, including, but not limited to, damages for loss of profits or loss of use.

NO AUTHORIZATION

No person or firm is authorized to create for Midmark any other obligation or liability in connection with the products.

THIS WARRANTY IS MIDMARK'S ONLY WARRANTY AND IS IN LIEU OF ALL OTHER WARRANTIES, EXPRESS OR IMPLIED. MIDMARK MAKES NO IMPLIED WARRANTIES OF ANY KIND INCLUDING ANY WARRANTIES OF MERCHANTABILITY OR FITNESS FOR ANY PARTICULAR PURPOSE. THIS WARRANTY IS LIMITED TO THE REPAIR OR REPLACEMENT OF DEFECTIVE PARTS.

Midmark Corporation

For contact information, go to:

www.midmark.com



Because we care.